

*RU*

Interval <input type="checkbox"/> 60 min.	<input checked="" type="checkbox"/> 15 min.
<input type="checkbox"/> Binned(CL/SP)	<input checked="" type="checkbox"/> Count(volume)
Lane No <input checked="" type="checkbox"/> 1 <input type="checkbox"/> 2	
Direction Channel 1 _____	
Direction Channel 2 _____	
Data Hog # _____	

Counter No. <u>031946</u>	Count ID <u>10-001</u>
SR <u>14</u> RRT/RRQ <u>P1 00299</u>	MP <u>0.00</u>
Leg <u>2</u>	Direction <u>EB</u> OSID _____

Station Description ON SR 14 EB OFF RAMP TO SE COLUMBIA WAY

Date	Day	Time	Comments			
1/11/10	2	1053	Manual (1) <u>5</u> (2) _____	Counter (1) <u>5</u> (2) _____	SET OK	JJ/RT 5.3
1/12	3	1112	Manual (1) <u>7</u> (2) _____	Counter (1) <u>7</u> (2) _____	CHECK OK	JJ/RT 5.2
1/13	4	0940	Manual (1) <u>4</u> (2) _____	Counter (1) <u>4</u> (2) _____	CHECK OK	JJ/RT 5.1
1/14	5	1058	Manual (1) <u>2</u> (2) _____	Counter (1) <u>2</u> (2) _____	CHECK OK	JJ/RT 5.8
1/15	6	<u>0816</u>	Manual (1) <u>1</u> (2) _____	Counter (1) <u>1</u> (2) _____	P/U OK	JJ/RT <u>5.1</u>

Sketch

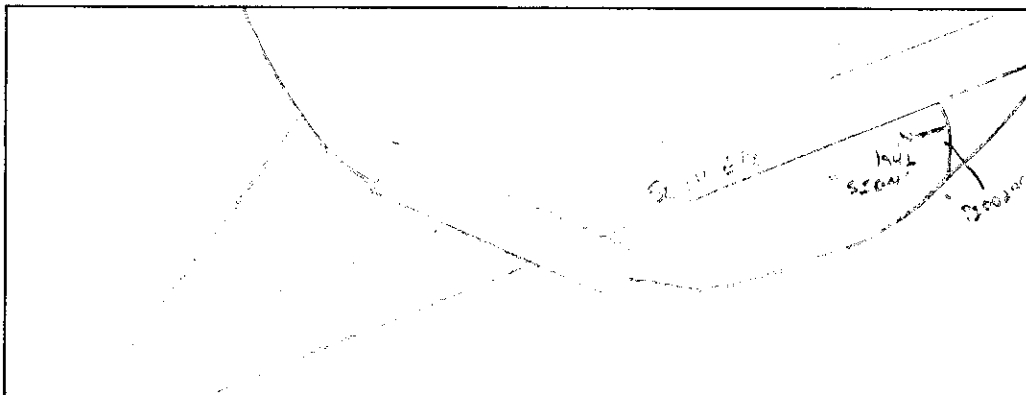

JJ RT  
Field Person



SR 014 P100299 MP 000.00 OFF SYSTEM ID. LEG 2 DIRECTION OF TRAFFIC EASTBOUND LANE ALL OF  
 COUNT IDENTIFIER 10-001 COUNTER NUMBER 031946 DESCRIPTION: ON SR 14 EB OFF RAMP TO SE COLUMBIA WAY

01/14/10	THURSDAY	AM HOURS												PM HOURS												DAILY TOTAL
		1	2	3	4	5	6	7	8	9	10	11	12	1	2	3	4	5	6	7	8	9	10	11	12	
12	1	2	3	4	5	6	7	8	9	10	11	12	1	2	3	4	5	6	7	8	9	10	11	12	112	
1	2	3	4	5	6	7	8	9	10	11	12	1	2	3	4	5	6	7	8	9	10	11	12	112		
2	2	2	2	1	1	3	10	13	13	12	17	29	17	28	46	37	53	24	27	18	17	10	9	345		
2	1	1	2	1	1	2	10	13	11	16	21	20	23	30	35	40	37	24	18	13	20	14	2	1089		
1	3	2	1	2	2	3	13	13	11	12	22	31	18	23	38	28	37	23	10	16	12	6	3	112		
6	1	2	1	1	2	5	15	13	13	21	31	14	21	40	34	32	29	22	17	14	13	15	4	112		
TOT	11	7	2	3	4	13	48	52	48	61	91	94	79	121	151	137	156	93	72	61	62	45	18	1434		

AM PEAK HOUR 1100 TO 1200 VOLUME 91  
 PM PEAK HOUR 0445 TO 0545 VOLUME 159

01/15/10	FRIDAY	AM HOURS												PM HOURS												DAILY TOTAL
		1	2	3	4	5	6	7	8	9	10	11	12	1	2	3	4	5	6	7	8	9	10	11	12	
12	1	2	3	4	5	6	7	8	9	10	11	12	1	2	3	4	5	6	7	8	9	10	11	12	112	
1	2	3	4	5	6	7	8	9	10	11	12	1	2	3	4	5	6	7	8	9	10	11	12	112		
2	4	1	2	1	1	1	5	21																112		
4	2	2	1	1	1	2	4	15																112		
30-45	2	3	1	1	1	4	13																	112		
45-00	2	1	1	1	1	10	11																	112		
TOT	10	9	2	4	3	17	44	21																112		

AM PEAK HOUR 0715 TO 0815 VOLUME 60  
 PM PEAK HOUR 0000 TO 0000 VOLUME 0

01/11/10 THRU 01/15/10 TOTAL HOURS FOR COUNT 92  
 3 DAYS FACTOR GROUP P06  
 AVG WEEKDAY VOL 1406 X SEASONAL ADJ. FACTOR 0.9900 = 1392 X AXLE CORR FACTOR 0.9473 = ESTIMATED AVG DAILY TRAFFIC 1319  
 PEAK HOUR PERCENTAGES: K = 11.81 D = 100.00  
 PEAK HOUR LOCATION : VOLUME = 166 DATE: 01/11/10 TIME: 02:15 PM



*Ru*

Interval <input type="checkbox"/> 60 min.	<input checked="" type="checkbox"/> 15 min.
<input type="checkbox"/> Binned(CL/SP)	<input checked="" type="checkbox"/> Count(volume)
Lane No <input checked="" type="checkbox"/> 1 <input type="checkbox"/> 2	
Direction Channel 1 _____	
Direction Channel 2 _____	
Data Hog # _____	

Counter No. <u>035908</u>	Count ID <u>10-001</u>
SR <u>14</u> RRT/RRQ <u>Q1 00335</u>	MP <u>0.01</u> <del>0.00</del>
Leg <u>2</u>	Direction <u>EB</u> OSID _____

Station Description \_ ON SR 14 EB ON RAMP FROM SE COLUMBIA WAY

Date	Day	Time	Comments
1/11/10	2	1113	Manual (1) <u>5</u> (2) _____ SET OK JJ/RT 6.5 Counter (1) <u>5</u> (2)
1/12	3	1127	Manual (1) <u>7</u> (2) _____ CHECK OK JJ/RT 6.6 Counter (1) <u>7</u> (2)
1/13	4	0951	Manual (1) <u>1</u> (2) _____ CHECK OK JJ/RT 6.5 Counter (1) <u>1</u> (2)
1/14	5	1106	Manual (1) <u>5</u> (2) _____ CHECK OK JJ/RT 6.8 Counter (1) <u>5</u> (2)
1/15	6	<i>0824</i>	Manual (1) <u>1</u> (2) _____ P/U OK JJ/RT <i>6.4</i> Counter (1) <u>1</u> (2)

Sketch

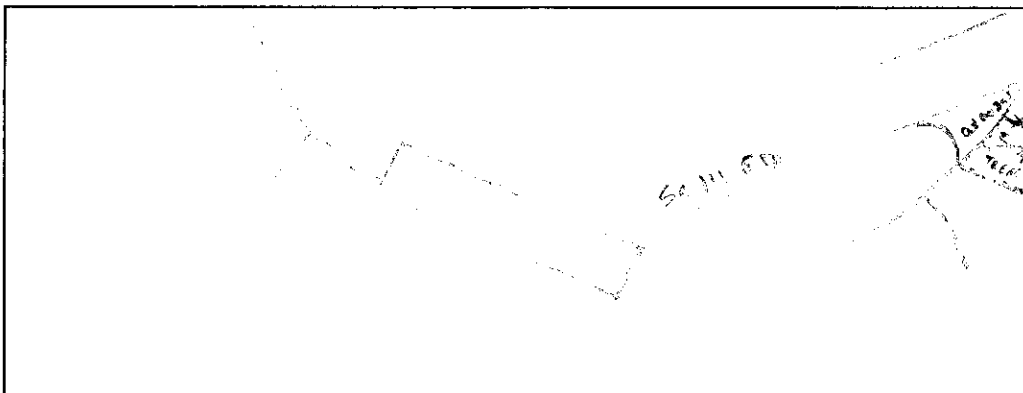

*5-11-10*  
Field Person

SR 014 Q100335 MP 000.01 OFF SYSTEM ID. LEG 2 DIRECTION OF TRAFFIC EASTBOUND LANE ALL OF

COUNT IDENTIFIER 10-001 COUNTER NUMBER 035908 DESCRIPTION: ON SR 14 EB ON RAMP FROM SE COLUMBIA WAY

COUNT IDENTIFIER	COUNTER NUMBER	DESCRIPTION	01/11/10 MONDAY												DAILY TOTAL										
			AM HOURS						PM HOURS																
12	1	2	3	4	5	6	7	8	9	10	11	12	1	2	3	4	5	6	7	8	9	10	11	12	
1	2	3	4	5	6	7	8	9	10	11	12	1	2	3	4	5	6	7	8	9	10	11	12		
TOT																									1315

AM PEAK HOUR 0000 TO 0000 VOLUME 0  
PM PEAK HOUR 0245 TO 0345 VOLUME 210

COUNT IDENTIFIER	COUNTER NUMBER	DESCRIPTION	01/12/10 TUESDAY												DAILY TOTAL										
			AM HOURS						PM HOURS																
12	1	2	3	4	5	6	7	8	9	10	11	12	1	2	3	4	5	6	7	8	9	10	11	12	
1	2	3	4	5	6	7	8	9	10	11	12	1	2	3	4	5	6	7	8	9	10	11	12		
TOT																									2116

AM PEAK HOUR 0730 TO 0830 VOLUME 192  
PM PEAK HOUR 0415 TO 0515 VOLUME 212

COUNT IDENTIFIER	COUNTER NUMBER	DESCRIPTION	01/13/10 WEDNESDAY												DAILY TOTAL										
			AM HOURS						PM HOURS																
12	1	2	3	4	5	6	7	8	9	10	11	12	1	2	3	4	5	6	7	8	9	10	11	12	
1	2	3	4	5	6	7	8	9	10	11	12	1	2	3	4	5	6	7	8	9	10	11	12		
TOT																									2182

AM PEAK HOUR 0715 TO 0815 VOLUME 183  
PM PEAK HOUR 0415 TO 0515 VOLUME 216

STATE OF WASHINGTON - DEPARTMENT OF TRANSPORTATION  
TRIP SYSTEM  
15 MINUTE TRAFFIC COUNT SUMMARY

SR 014 Q100335 MP 000.01 OFF SYSTEM ID. LEG 2 DIRECTION OF TRAFFIC EASTBOUND LANE ALL OF

COUNT IDENTIFIER 10-001 COUNTER NUMBER 035908 DESCRIPTION: ON SR 14 EB ON RAMP FROM SE COLUMBIA WAY

01/14/10	THURSDAY	AM HOURS												PM HOURS	DAILY TOTAL										
		1	2	3	4	5	6	7	8	9	10	11	12			1	2	3	4	5	6	7	8	9	10
12	1	2	3	4	5	6	7	8	9	10	11	12	1	2	3	4	5	6	7	8	9	10	11	12	92
1	2	3	4	5	6	7	8	9	10	11	12	1	2	3	4	5	6	7	8	9	10	11	12	363	
00-15	11	3	2	1	1	6	7	29	39	22	39	29	37	28	34	62	45	55	30	21	21	26	9	9	363
15-30	2	1	1	2	15	25	28	42	25	22	17	44	27	33	41	62	43	54	38	18	18	15	13	4	363
30-45	7	1	1	2	7	15	22	37	59	29	30	26	27	29	46	62	66	31	14	17	22	13	8	363	
45-00	1	1	1	1	8	32	40	30	30	30	27	35	35	26	29	51	41	33	22	15	19	8	2	363	
TOT	20	5	3	4	15	44	86	134	170	106	118	99	143	110	142	216	195	173	104	71	80	62	33	23	2156

AM PEAK HOUR 0745 TO 0845 VOLUME 180  
PM PEAK HOUR 0430 TO 0530 VOLUME 216

AM TOTAL 804  
PM TOTAL 1352

01/15/10	FRIDAY	AM HOURS												PM HOURS	DAILY TOTAL										
		1	2	3	4	5	6	7	8	9	10	11	12			1	2	3	4	5	6	7	8	9	10
12	1	2	3	4	5	6	7	8	9	10	11	12	1	2	3	4	5	6	7	8	9	10	11	12	92
1	2	3	4	5	6	7	8	9	10	11	12	1	2	3	4	5	6	7	8	9	10	11	12	363	
00-15	5	1	1	2	6	15	32	35																	363
15-30	4	1	1	4	6	8	26	32																	363
30-45	4	1	1	4	4	16	23	34																	363
45-00	4	2	4	10	6	28	49	35																	363
TOT	17	4	1	9	22	36	92	147	35																363

AM PEAK HOUR 0715 TO 0815 VOLUME 150  
PM PEAK HOUR 0000 TO 0000 VOLUME 0

AM TOTAL 363  
PM TOTAL 0

01/11/10 THRU 01/15/10 TOTAL HOURS FOR COUNT 92

3 DAYS FACTOR GROUP P06  
AVG WEEKDAY VOL 2151 X SEASONAL ADJ. FACTOR 0.9900 = 2129 X AXLE CORR FACTOR 0.9473 = ESTIMATED AVG DAILY TRAFFIC 2017

PEAK HOUR PERCENTAGES: K = 10.04 D = 100.00  
PEAK HOUR LOCATION : VOLUME = 216 DATE: 01/13/10 TIME: 04:15 PM



*RU*

Interval  60 min.  15 min.  
 Binned(CL/SP)  Count(volume)  
 Lane No  1  2

---

Direction Channel 1 \_\_\_\_\_  
 Direction Channel 2 \_\_\_\_\_  
 Data Hog # \_\_\_\_\_

Counter No. 035905 Count ID 10-001  
 SR 14 RRT/RRQ S1 00263 MP 0.00  
 Leg 2 Direction WB OSID \_\_\_\_\_

Station Description \_ ON SR 14 WB ON RAMP FROM SE COLUMBIA WAY

Date	Day	Time	Comments		
1/11/10	2	1217	Manual (1) <u>5</u> (2) _____ Counter (1) <u>5</u> (2)	SET OK	JJ/RT 6.4
1/12	3	1224	Manual (1) <u>4</u> (2) _____ Counter (1) <u>4</u> (2)	CHECK OK	JJ/RT 6.7
1/13	4	1050	Manual (1) <u>3</u> (2) _____ Counter (1) <u>3</u> (2)	CHECK OK	JJ/RT 6.5
1/14	5	1209	Manual (1) <u>4</u> (2) _____ Counter (1) <u>4</u> (2)	CHECK OK	JJ/RT 6.7
1/15	6	<u>0856</u>	Manual (1) <u>1</u> (2) _____ Counter (1) <u>1</u> (2)	P/U OK	JJ/RT <u>6.4</u>

Sketch

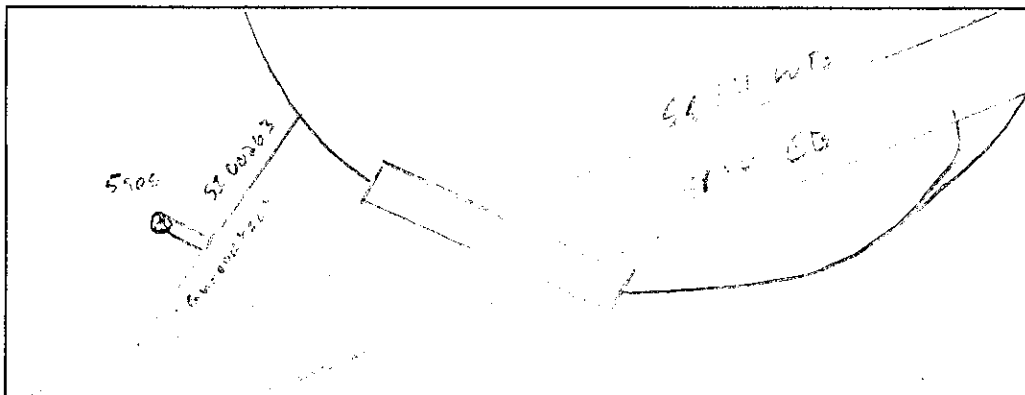

JJ/RT  
Field Person

STATE OF WASHINGTON - DEPARTMENT OF TRANSPORTATION  
 TRIP SYSTEM  
 HOURLY TRAFFIC CLASSIFICATION SUMMARY

SR 014 S100263 MP 000.00

OFF SYSTEM ID.

LEG 2

DIRECTION OF TRAFFIC WESTBOUND

LANE ALL OF

COUNT IDENTIFIER 10-001

COUNTER NUMBER 035905

DESCRIPTION: ON SR 14 WB ON RAMP FROM SE COLUMBIA WAY

01-11-10 MONDAY AM HOURS	CARS PICKUPS	BUS	SINGLE MED	UNITS HVY	4+ SINGLE UNIT %	DOUBLE UNITS 4- 5	DOUBLE UNITS 6+ UNIT %	DOUBLE UNITS 5- 6	TRAINS 7+ UNIT %	TRAIN %	TRUCK %	CLASS UNKNOWN	TOTAL VEHICLES
12 - 1	1												1
11 - 2	2												2
10 - 3	3												3
9 - 4	4												4
8 - 5	5												5
7 - 6	6												6
6 - 7	7												7
5 - 8	8												8
4 - 9	9												9
3 - 10	10												10
2 - 11	11												11
1 - 12	12												12
PM HOURS													
12 - 1	86				6.5						6.5		92
11 - 2	73				9.9						9.9		81
10 - 3	98	4	4	2	17.6						17.6		119
9 - 4	85	17	2	1	4.5						4.5		89
8 - 5	91	3	1		3.2						3.2		94
7 - 6	67	1	1		1.5						1.5		68
6 - 7	35				4.8						4.8		35
5 - 8	20												21
4 - 9	25												25
3 - 10	18												18
2 - 11	10												10
1 - 12	10												10
AM TOTAL	608	25	14	5	6.7						6.7		652
PM TOTAL	608	25	14	5	6.7						6.7		652
DAY TOTAL	608	25	14	5	6.7						6.7		652

2-AXLE EQUIVALENT 655





SR 014 S100263 MP 000.00 OFF SYSTEM ID. LEG 2 DIRECTION OF TRAFFIC WESTBOUND LANE ALL OF  
COUNT IDENTIFIER 10-001 COUNTER NUMBER 035905 DESCRIPTION: ON SR 14 WB ON RAMP FROM SE COLUMBIA WAY

01-13-10 WEDNESDAY AM HOURS	CARS PICKUPS	BUS	SINGLE MED	UNITS HVV	4+	SINGLE UNIT %	DOUBLE 4-	UNITS 5	6+	DOUBLE UNIT %	5-	TRAINS 6	7+	TRAIN %	TRUCK %	CLASS UNKNOWN	TOTAL VEHICLES
12 - 1	2																2
1 - 2	2																2
2 - 3	6																3
3 - 4	3																3
4 - 5	8	1				11.1			1	14.3				11.1		9	
5 - 6	27					.9								.9		27	
6 - 7	55					2.4								2.4		55	
7 - 8	111					4.2								4.2		112	
8 - 9	83					3.3	1		1	1.1				4.4		85	
9 - 10	69					2.3								3.4		72	
10 - 11	87					6.5			1	1.1				4.2		88	
11 - 12	85	1				4.2								4.2		77	
PM HOURS						19.8								9.9		96	
12 - 1	72	1				9.9								4.3		81	
1 - 2	92	3				1.3								1.3		94	
2 - 3	77	16				1.9								1.9		78	
3 - 4	73	6				1.9								1.9		54	
4 - 5	73	1				1.9								1.9		29	
5 - 6	90					1.7								1.7		34	
6 - 7	77					5.8								5.8		19	
7 - 8	53					1.7								1.7		12	
8 - 9	29					1.1								1.1		12	
9 - 10	34					1.1								1.1		12	
10 - 11	19					1.1								1.1		12	
11 - 12	12					1.1								1.1		12	
AM TOTAL	566	1	8	1	1	1.7	1	1	1	.5				2.2		579	
PM TOTAL	713	27	16	1	1	5.8	1	1	1	.1				5.9		758	
DAY TOTAL	1279	28	24	2	2	4.0	1	2	1	.3				4.3		1337	
-----																	
2-AXLE EQUIVALENT																	
1344																	

STATE OF WASHINGTON - DEPARTMENT OF TRANSPORTATION  
 TRIP SYSTEM  
 HOURLY TRAFFIC CLASSIFICATION SUMMARY

SR	COUNT	IDENTIFIER	MP	OFF SYSTEM ID.	COUNTER NUMBER	DESCRIPTION	LEG	DIRECTION OF TRAFFIC	LANE	ALL	OF						
01-14-10	THURSDAY	CARS	10-001	035905	ON SR 14	WB ON RAMP FROM SE COLUMBIA WAY	2	WESTBOUND	ALL								
AM HOURS	PICKUPS	BUS	MED	HVY	4+	SINGLE UNIT %	DOUBLE UNITS 4-	5	6+	DOUBLE UNIT %	5-	6	7+	TRAIN %	TRUCK %	CLASS UNKNOWN	TOTAL VEHICLES
12 - 1	3																3
1 - 2	4																4
2 - 3	3																3
3 - 4	5																5
4 - 5	9					10.0											10
5 - 6	26																26
6 - 7	63					3.1											65
7 - 8	98					2.0											100
8 - 9	132					1.5											134
9 - 10	73					2.6											77
10 - 11	78					4.9											82
11 - 12	91					2.2											93
PM HOURS																	
12 - 1	102					5.6											108
1 - 2	95					2.0											98
2 - 3	91					4.1											97
3 - 4	96					17.2											116
4 - 5	104					6.3											111
5 - 6	80					1.2											81
6 - 7	78																78
7 - 8	49					3.9											51
8 - 9	37																37
9 - 10	38																39
10 - 11	27					2.6											27
11 - 12	12																12
AM TOTAL	585					2.5											602
PM TOTAL	809					5.0											855
DAY TOTAL	1394					4.0											1457
-----																	
2-AXLE EQUIVALENT																	
1464																	

SR 014 S100263 MP 000.00 OFF SYSTEM ID. LEG 2 DIRECTION OF TRAFFIC WESTBOUND LANE ALL OF  
 COUNT IDENTIFIER 10-001 COUNTER NUMBER 035905 DESCRIPTION: ON SR 14 WB ON RAMP FROM SE COLUMBIA WAY

01-15-10	CARS PICKUPS	BUS MED	SINGLE UNITS 4+	SINGLE UNIT %	DOUBLE UNITS 4-5	DOUBLE UNITS 6+	DOUBLE UNIT %	5-6	TRAINS 7+	TRAIN %	TRUCK %	CLASS UNKNOWN	TOTAL VEHICLES
FRIDAY AM HOURS	11		1	20.0							20.0		11
1 - 2	4												5
2 - 3	8												8
3 - 4	7		1										7
4 - 5	8			11.1							11.1		9
5 - 6	29			1.7							1.7		29
6 - 7	57		1	2.2							2.2		58
7 - 8	90		2										92
8 - 9													
9 - 10													
10 - 11													
11 - 12													
AM TOTAL	214	2	3	2.3							2.3		219
PM TOTAL													
DAY TOTAL	214	2	3	2.3							2.3		219

01-11-10 THRU 01-15-10  
 AVERAGE WEEKDAY CLASSIFICATION VOLUMES \*\*\*\*\*  
 CARS PICKUPS | BUS MED HVY 4+ | SINGLE UNIT % | DOUBLE UNITS 4-5 | DOUBLE UNITS 6+ | DOUBLE UNIT % | 5-6 | TRAINS 7+ | TRAIN % | TRUCK % | CLASS UNKNOWN | TOTAL VEHICLES  
 1337 29 30 4 4.5 1 3 .3 4.8  
 AND 2-AXLE EQUIVALENT 1412

TOTAL HOURS FOR COUNT 91  
 3 DAYS FACTOR GROUP P06  
 AVG WEEKDAY VOL 1405 X SEASONAL ADJ. FACTOR 0.9900 = ESTIMATED AVG DAILY TRAFFIC 1391  
 PEAK HOUR PERCENTAGES: K = 9.54 D = 100.00 T = 1.49  
 PEAK HOUR LOCATION : VOLUME = 134 DATE: 01/14/10 TIME: 08:00 AM



RW

Interval  60 min.  15 min.  
 Binned(CL/SP)  Count(volume)  
Lane No  1  2

Direction Channel 1 \_\_\_\_\_  
Direction Channel 2 \_\_\_\_\_  
Data Hog # \_\_\_\_\_

Counter No. 035899 Count ID 10-001  
SR 14 RRT/RRQ R1 00369 MP 0.00  
Leg 2 Direction WB OSID \_\_\_\_\_

Station Description \_ ON SR 14 WB OFF RAMP TO EVERGREEN BLVD

Date	Day	Time	Comments		
1/11/10	2	1206	Manual (1) <u>5</u> (2) _____ Counter (1) <u>5</u> (2) _____	SET OK	JJ/RT 6.5
1/12	3	1215	Manual (1) <u>11</u> (2) _____ Counter (1) <u>11</u> (2) _____	CHECK OK	JJ/RT 6.6
1/13	4	1044	Manual (1) <u>1</u> (2) _____ Counter (1) <u>1</u> (2) _____	CHECK OK	JJ/RT 6.5
1/14	5	1202	Manual (1) <u>9</u> (2) _____ Counter (1) <u>9</u> (2) _____	CHECK OK	JJ/RT 6.7
1/15	6	<u>0851</u>	Manual (1) <u>1</u> (2) _____ Counter (1) <u>1</u> (2) _____	P/U OK	JJ/RT <u>6.5</u>

Sketch

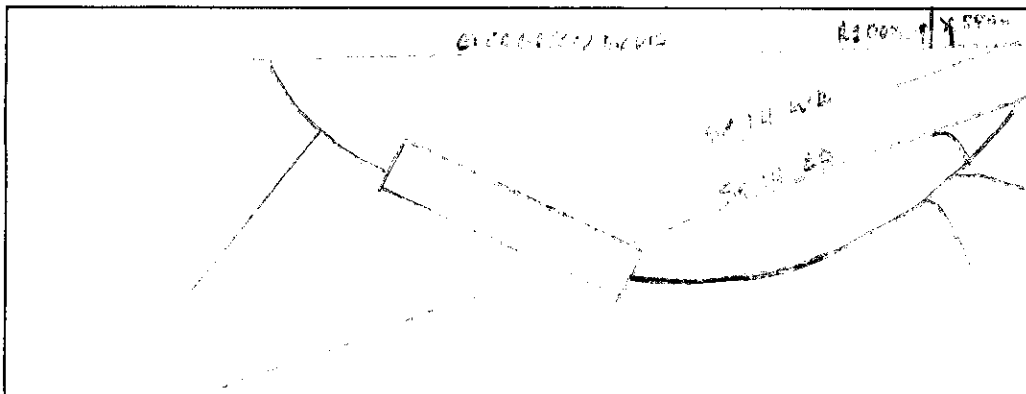

53167  
Field Person



SR 014 R100369 MP 000.00 OFF SYSTEM ID. LEG 2 DIRECTION OF TRAFFIC WESTBOUND LANE ALL OF

COUNT IDENTIFIER 10-001 COUNTER NUMBER 035899 DESCRIPTION: ON SR 14 WB OFF RAMP TO EVERGREEN BLVD

01/14/10 THURSDAY	AM HOURS												PM HOURS												DAILY TOTAL
	12	1	2	3	4	5	6	7	8	9	10	11	12	1	2	3	4	5	6	7	8	9	10	11	
12	1	2	3	4	5	6	7	8	9	10	11	12	1	2	3	4	5	6	7	8	9	10	11	12	1095
1	2	3	4	5	6	7	8	9	10	11	12	1	2	3	4	5	6	7	8	9	10	11	12	1873	
6	5	3	1	1	7	10	35	77	39	33	44	33	38	49	68	68	40	64	31	14	15	19	11	11	
15-30	6	2	1	1	4	17	54	105	34	28	25	24	28	48	56	55	57	46	29	27	21	15	10	10	
30-45	4	1	1	1	4	16	55	38	31	42	44	29	35	80	56	68	64	54	24	23	21	11	6	6	
45-00	2	4	2	2	3	18	45	42	47	42	41	38	48	110	68	62	61	51	28	29	13	16	12	12	
TOT	18	12	6	6	9	39	88	205	262	151	145	154	124	149	287	248	253	222	215	112	93	70	61	39	2968
									AM PEAK HOUR 0730 TO 0830 VOLUME												AM TOTAL				1095
									PM PEAK HOUR 0230 TO 0330 VOLUME												PM TOTAL				1873

01/15/10 FRIDAY	AM HOURS												PM HOURS												DAILY TOTAL
	12	1	2	3	4	5	6	7	8	9	10	11	12	1	2	3	4	5	6	7	8	9	10	11	
12	1	2	3	4	5	6	7	8	9	10	11	12	1	2	3	4	5	6	7	8	9	10	11	12	615
1	2	3	4	5	6	7	8	9	10	11	12	1	2	3	4	5	6	7	8	9	10	11	12	615	
9	3	4	1	2	3	8	31	75	39	33	44	33	38	49	68	68	40	64	31	14	15	19	11	11	
15-30	9	1	1	1	2	9	16	50	34	28	25	24	28	48	56	55	57	46	29	27	21	15	10	10	
30-45	7	2	3	3	4	5	24	56	31	42	44	29	35	80	56	68	64	54	24	23	21	11	6	6	
45-00	5	3	1	1	4	15	38	61	42	47	42	41	38	48	110	68	62	61	51	28	29	13	16	12	
TOT	30	9	10	7	12	32	86	198	231	151	145	154	124	149	287	248	253	222	215	112	93	70	61	39	2968
									AM PEAK HOUR 0730 TO 0830 VOLUME												AM TOTAL				615
									PM PEAK HOUR 0000 TO 0000 VOLUME												PM TOTAL				0

01/11/10 THRU 01/15/10 TOTAL HOURS FOR COUNT 91

3 DAYS  
 AVG WEEKDAY VOL 2953 X SEASONAL ADJ. FACTOR 0.9900 = 2923 X AXLE CORR FACTOR 0.9473 = ESTIMATED AVG DAILY TRAFFIC 2769  
 PEAK HOUR PERCENTAGES: K = 10.94 D = 100.00  
 PEAK HOUR LOCATION : VOLUME = 323 DATE: 01/12/10 TIME: 07:30 AM