



Washington State
Department of Transportation

Diamond Traffic Counter

RU

Interval 60 min. 15 min.
 Binned(CL/SP) Count(volume)
 Lane No 1 2
 Direction Channel 1 _____
 Direction Channel 2 _____
 Unique ID# _____

Counter No. 45 1962 Count ID HPMS
455908
 SR 14 RRT/RRQ MP 21.77
 Leg <-> Direction WB OSID _____

AT
 Station Description _ON SR 14 CLARK / SKAMANIA CO. LINE

Date	Day	Time	Comments
10/31/16	2	1458	Manual (1) 2 (2) SET OK RT 6.3V Counter (1) 2 (2)
11/1	3	1138	Manual (1) 15 (2) CHECK OK RT 6.2V Counter (1) 15 (2) <i>RESET WITH 1962</i> <i>NOT COLLECTING PROPERLY</i>
11/2	4	0911	Manual (1) 6 (2) CHECK OK RT 6.4V Counter (1) 6 (2)
11/3	5	1101	Manual (1) 10 (2) CHECK OK RT 6.6V Counter (1) 10 (2)
11/4	6	1016	Manual (1) 1 (2) P/U OK RT 6.5V Counter (1) 1 (2)

DEL WB FROM CLASSCNT. - RU

Sketch

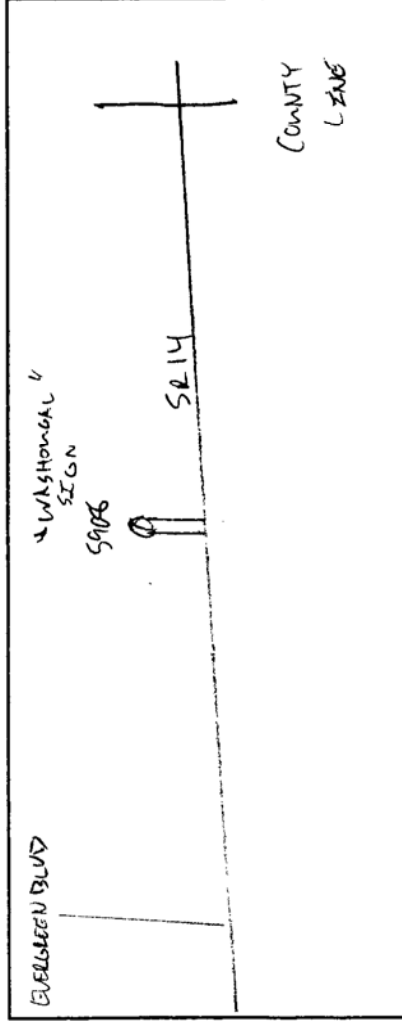

North

Field Person PT



Washington State
Department of Transportation

Diamond Traffic Counter

RW

Interval 60 min. 15 min.
 Binned(CL/SP) Count(volume)
 Lane No 1 2
 Direction Channel 1 _____
 Direction Channel 2 _____
 Unique ID# _____

Counter No. 45 ~~441954~~ Count ID HPMS
 SR 14 RRT/RRQ _____ MP 21.77
 Leg <-> Direction EB OSID _____

Station Description _ ON SR 14 AT CLARK / SKAMANIA CO. LINE

Date	Day	Time	Comments
10/31/16	2	1454	Manual (1) 2 (2) SET OK RT 6.5V Counter (1) 2 (2)
11/1	3	0904	Manual (1) 5 (2) CHECK OK RT 6.5V Counter (1) 5 (2) A TUBE UNPLUGGED RESET OK
11/2	4	0830	Manual (1) 4 (2) CHECK OK RT 6.3V Counter (1) 4 (2)
11/3	5	1133	Manual (1) 10 (2) CHECK OK RT 6.5V Counter (1) 10 (2)
11/4	6	1017	Manual (1) 1 (2) P/U OK RT 6.5V Counter (1) 1 (2)

Sketch

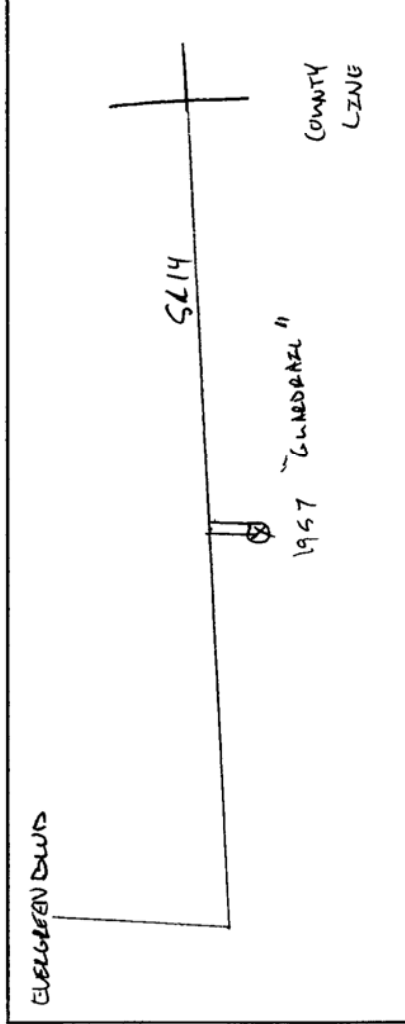

North

L7

Field Person

STATE OF WASHINGTON - DEPARTMENT OF TRANSPORTATION
 TRIP SYSTEM
 HOURLY TRAFFIC CLASSIFICATION SUMMARY

SR 014 MP 021.77 OFF SYSTEM ID. LEG DIRECTION OF TRAFFIC WESTBOUND LANE ALL OF
 COUNT IDENTIFIER HPMS COUNTER NUMBER 455908 * DESCRIPTION: ON SR 14 AT CLARK/SKAMANIA CO LINE

10-31-16																		
MONDAY																		
AM HOURS	CARS PICKUPS	SINGLE UNITS				SINGLE UNIT %	DOUBLE UNITS			DOUBLE UNIT %	TRAINS			TRAIN %	TRUCK %	CLASS UNKNOWN	TOTAL VEHICLES	
		BUS	MED	HVY	4+		4-	5	6+		5-	6	7+					
12 - 1																		
1 - 2																		
2 - 3																		
3 - 4																		
4 - 5																		
5 - 6																		
6 - 7																		
7 - 8																		
8 - 9																		
9 - 10																		
10 - 11																		
11 - 12																		
PM HOURS																		
12 - 1																		
1 - 2																		
2 - 3																		
3 - 4	175	1	6	5		6.0	2	6	2	5.0		2		1.0	12.1		199	
4 - 5	195		11	1		5.4		4	10	6.3		1		.5	12.2		222	
5 - 6	179		10	2		6.1	1		2	1.5		2		1.0	8.7		196	
6 - 7	103		7	1		7.1		2		1.8					8.8		113	
7 - 8	48		2			3.6		3	1	7.3		1		1.8	12.7		55	
8 - 9	34		1			2.6	1	2	1	10.3					12.8		39	
9 - 10	28		1			3.0		4		12.1					15.2		33	
10 - 11	10		1			6.3		3	1	25.0	1			6.3	37.5		16	
11 - 12	4							2	1	42.9					42.9		7	

AM TOTAL																		
PM TOTAL	776	1	39	9		5.6	4	26	18	5.5	1	6		.8	11.8		880	
DAY TOTAL	776	1	39	9		5.6	4	26	18	5.5	1	6		.8	11.8		880	
															2-AXLE EQUIVALENT		980	

STATE OF WASHINGTON - DEPARTMENT OF TRANSPORTATION
 TRIP SYSTEM
 HOURLY TRAFFIC CLASSIFICATION SUMMARY

SR 014 MP 021.77 OFF SYSTEM ID. LEG DIRECTION OF TRAFFIC WESTBOUND LANE ALL OF
 COUNT IDENTIFIER HPMS COUNTER NUMBER 455908 * DESCRIPTION: ON SR 14 AT CLARK/SKAMANIA CO LINE

11-01-16 TUESDAY AM HOURS	CARS PICKUPS	SINGLE UNITS				SINGLE UNIT %	DOUBLE UNITS			DOUBLE UNIT %	TRAINS			TRAIN %	TRUCK %	CLASS UNKNOWN	TOTAL VEHICLES
		BUS	MED	HVY	4+		4-	5	6+		5-	6	7+				
12 - 1									100.0					100.0			3
1 - 2	5							1	25.0					37.5			8
2 - 3	6							3	40.0				1	40.0			10
3 - 4	5							1	16.7					16.7			6
4 - 5	30		2			5.6		1	11.1					16.7			36
5 - 6	81		6			6.7		1	3.3					10.0			90
6 - 7	122		15			10.3		4	4.8				1	15.8	1		146
7 - 8	147	1	6	1		4.9	2	2	2.5			2	1.2	8.6	1		162
8 - 9	133	1	4	1		4.2		4	2.8			1	.7	7.6			144
9 - 10	91		9			8.0	2	3	9.8			1	.9	18.8			112
10 - 11	103	1	4	4		7.2	2	6	10.4					17.6			125
11 - 12																	
PM HOURS																	
12 - 1	108	1	9	4		10.4	3	1	4.5			6	4.5	19.4			134
1 - 2	134	3	14	3	1	12.5	1	7	4.8			5	3.0	20.2			168
2 - 3	158	3	5	1		4.9	2	11	8.2			2	1.1	14.1			184
3 - 4	165		12	5		8.6	1	8	6.1			3	1.5	16.2			197
4 - 5	221		16	2		7.2		7	4.4			1	.4	12.0			251
5 - 6	198		17			7.7		2	2.7			1	.5	10.8			222
6 - 7	123		5			3.8		4	3.0					6.8			132
7 - 8	51		3			5.3		1	5.3					10.5			57
8 - 9	31		4			10.0		4	10.0			1	2.5	22.5			40
9 - 10	24		4	1		14.7		2	11.8			1	2.9	29.4			34
10 - 11	12		1			6.7		2	13.3					20.0			15
11 - 12	10		1			8.3						1	8.3	16.7			12
AM TOTAL	723	3	46	6		6.5	6	21	6.7			6	.7	13.9	2		842
PM TOTAL	1235	7	91	16	1	8.0	7	28	5.2			21	1.5	14.6			1446
DAY TOTAL	1958	10	137	22	1	7.4	13	49	5.7			27	1.2	14.3	2		2288
														2-AXLE EQUIVALENT			2592

Count Low

STATE OF WASHINGTON - DEPARTMENT OF TRANSPORTATION
 TRIP SYSTEM
 HOURLY TRAFFIC CLASSIFICATION SUMMARY

SR 014 MP 021.77 OFF SYSTEM ID. LEG DIRECTION OF TRAFFIC WESTBOUND LANE ALL OF
 COUNT IDENTIFIER HPMS COUNTER NUMBER 455908 * DESCRIPTION: ON SR 14 AT CLARK/SKAMANIA CO LINE

11-02-16 WEDNESDAY		CARS PICKUPS	SINGLE UNITS				SINGLE UNIT %	DOUBLE UNITS			DOUBLE UNIT %	TRAINS			TRAIN %	TRUCK %	CLASS UNKNOWN	TOTAL VEHICLES
AM HOURS			BUS	MED	HVY	4+		4-	5	6+		5-	6	7+				
12 - 1		5								16.7					16.7			6
1 - 2		1								50.0				1	25.0			4
2 - 3		4								33.3								6
3 - 4		4			1		20.0											5
4 - 5		34			2		5.1			7.7								39
5 - 6		94			9	1	9.1			3.6			1	.9			1	110
6 - 7		110			14		10.7			4.6				.8				131
7 - 8		146		1	8	1	6.1		1	4.3							1	164
8 - 9		144		2	6	1	5.6			3.1				1.3				160
9 - 10		92		1	7	1	8.0			9.7				.9				113
10 - 11		108		1	10		8.5		1	7.7				.8				130
11 - 12		98		1	6		5.7		3	10.7				3.3				122
PM HOURS																		
12 - 1		135		1	11	4	9.6		3	8.4				1.2				167
1 - 2		143			9	2	6.3		2	9.1				2.9				175
2 - 3		162			16	1	8.8		1	5.7				1.6				193
3 - 4		175		2	19	1	10.5			4.3				1.0			1	209
4 - 5		211		2	19	2	9.1		8	6.7				.8				253
5 - 6		212			18	1	7.8		3	4.5							1	243
6 - 7		140			11		7.0		1	3.2				.6				157
7 - 8		51			5		8.1		1	8.1							1	62
8 - 9		22			3		9.7			19.4								31
9 - 10		16			1		4.5			22.7								22
10 - 11		13							1	22.2								18
11 - 12		12								7.7								13
AM TOTAL		840		6	63	4	7.4		6	6.5			1	1.1			2	990
PM TOTAL		1292		5	112	11	8.3		19	6.7				1.0			3	1543
DAY TOTAL		2132		11	175	15	7.9		25	6.6			1	1.1			5	2533
																	2-AXLE EQUIVALENT	2888

STATE OF WASHINGTON - DEPARTMENT OF TRANSPORTATION
 TRIP SYSTEM
 HOURLY TRAFFIC CLASSIFICATION SUMMARY

SR 014 MP 021.77 OFF SYSTEM ID. LEG DIRECTION OF TRAFFIC WESTBOUND LANE ALL OF
 COUNT IDENTIFIER HPMS COUNTER NUMBER 455908 * DESCRIPTION: ON SR 14 AT CLARK/SKAMANIA CO LINE

11-03-16 THURSDAY		CARS PICKUPS	SINGLE UNITS				SINGLE UNIT %	DOUBLE UNITS			DOUBLE UNIT %	TRAINS			TRAIN %	TRUCK %	CLASS UNKNOWN	TOTAL VEHICLES
AM HOURS	PM HOURS		BUS	MED	HVY	4+		4-	5	6+		5-	6	7+				
12 - 1		8						1		10.0					10.0	1	10	
1 - 2		2							2	60.0					60.0		5	
2 - 3		2						3	1	66.7					66.7		6	
3 - 4		8						1	1	18.2			1	9.1	27.3		11	
4 - 5		34		3		6.8	1	3	3	15.9					22.7		44	
5 - 6		83		5		5.3		3	2	5.3					10.6	1	94	
6 - 7		139		10		6.5		1	3	2.6			1	.6	9.7		154	
7 - 8		131	1	5	1	4.9		2	2	2.8					7.7		142	
8 - 9		126	3	6	4	8.6	1	2	6	6.0		1	2	2.0	16.6		151	
9 - 10		98	1	8	4	10.1	4	5	5	10.9			4	3.1	24.0		129	
10 - 11		109	1	16	1	12.9	1	2	7	7.2			2	1.4	21.6		139	
11 - 12		110	2	3	4	6.7		4	8	9.0			3	2.2	17.9		134	
PM HOURS																		
12 - 1		132	2	13	4	11.7	1	6	5	7.4					19.0		163	
1 - 2		138	1	11	2	8.0	3	7	8	10.3			4	2.3	20.7		174	
2 - 3		181		16	3	9.3	1	9	11	9.3			2	.9	19.6		225	
3 - 4		221	1	22	3	10.3	2	6	6	5.3			1	.4	16.0		263	
4 - 5		253	2	29	2	11.0	3	3	8	4.7					15.6	1	301	
5 - 6		270	2	21	1	7.8	1	5	7	4.2					12.1		307	
6 - 7		182		7	1	3.9	4	7	1	5.9					9.8	2	204	
7 - 8		64		1		1.4	1	2	2	7.1					8.6		70	
8 - 9		31		1		2.7	1	3	1	13.5					16.2		37	
9 - 10		23	1	3		12.5		2		6.3			3	9.4	28.1		32	
10 - 11		15						2		11.8					11.8		17	
11 - 12		14							1	6.3			1	6.3	12.5		16	
AM TOTAL		850	8	56	14	7.7	7	27	41	7.4			1	13	16.4	2	1019	
PM TOTAL		1524	9	124	16	8.4	17	52	50	6.6				11	15.6	3	1809	
DAY TOTAL		2374	17	180	30	8.1	24	79	91	6.9			1	24	15.9	5	2828	
2-AXLE EQUIVALENT																		
3233																		

STATE OF WASHINGTON - DEPARTMENT OF TRANSPORTATION
 TRIPS SYSTEM
 HOURLY TRAFFIC CLASSIFICATION SUMMARY

SR 014 MP 021.77 OFF SYSTEM ID. LEG DIRECTION OF TRAFFIC WESTBOUND LANE ALL OF

COUNT IDENTIFIER HPMS COUNTER NUMBER 455908 * DESCRIPTION: ON SR 14 AT CLARK/SKAMANIA CO LINE

FRIDAY AM HOURS	CARS PICKUPS	SINGLE UNITS				SINGLE UNIT %	DOUBLE UNITS			DOUBLE UNIT %	TRAINS			TRAIN %	TRUCK %	CLASS UNKNOWN	TOTAL VEHICLES
		BUS	MED	HVY	4+		4-	5	6+		5-	6	7+				
12 - 1	3		1			25.0								25.0			4
1 - 2	4							2	33.3					33.3			6
2 - 3	5			1		11.1		3	33.3					44.4			9
3 - 4	6							1	25.0	1				25.0			8
4 - 5	33		1			2.6		2	10.5	2				13.2			38
5 - 6	74		3			3.6		1	6.0	4		1	1.2	10.8			83
6 - 7	114		9			7.0		4	3.9	1		1	.8	11.6			129
7 - 8	128		11			7.7		4	2.8					10.5			143
8 - 9	141	2	9	2		7.9	1	3	6.7	7				14.5			165
9 - 10	144	1	6	1		5.0	1	2	5.0	5		1	.6	10.6			161
10 - 11																	
11 - 12																	
PM HOURS																	
12 - 1																	
1 - 2																	
2 - 3																	
3 - 4																	
4 - 5																	
5 - 6																	
6 - 7																	
7 - 8																	
8 - 9																	
9 - 10																	
10 - 11																	
11 - 12																	
AM TOTAL	652	3	40	4		6.3	2	18	24	5.9		3	.4	12.6			746
PM TOTAL																	
DAY TOTAL	652	3	40	4		6.3	2	18	24	5.9		3	.4	12.6	2-AXLE EQUIVALENT		833

10-31-16 THRU 11-04-16

AVERAGE WEEKDAY CLASSIFICATION VOLUMES *****

AVG WEEKDAY VOLUME	CARS PICKUPS	SINGLE UNITS				SINGLE UNIT %	DOUBLE UNITS			DOUBLE UNIT %	TRAINS			TRAIN %	TRUCK %	CLASS UNKNOWN	TOTAL VEHICLES
		BUS	MED	HVY	4+		4-	5	6+		5-	6	7+				
2253		14	178	23	2	8.1	25	70	87	6.8	1	1	25	1.0	15.9	5	2681
TOTAL HOURS FOR COUNT		90															
2 DAYS		FACTOR GROUP P07															
AVG WEEKDAY VOL		2681 X SEASONAL ADJ. FACTOR 1.0700 = ESTIMATED AVG DAILY TRAFFIC 2869															

STATE OF WASHINGTON - DEPARTMENT OF TRANSPORTATION
 T R I P S S Y S T E M
 HOURLY TRAFFIC CLASSIFICATION SUMMARY

SR 014 MP 021.77 OFF SYSTEM ID. LEG DIRECTION OF TRAFFIC EASTBOUND LANE ALL OF
 COUNT IDENTIFIER HPMS COUNTER NUMBER 451954 DESCRIPTION: ON SR 14 AT CLARK/SKAMANIA CO LINE

10-31-16 MONDAY AM HOURS	CARS PICKUPS	SINGLE UNITS				SINGLE UNIT %	DOUBLE UNITS			DOUBLE UNIT %	TRAINS			TRAIN %	TRUCK %	CLASS UNKNOWN	TOTAL VEHICLES
		BUS	MED	HVY	4+		4-	5	6+		5-	6	7+				
12 - 1																	
1 - 2																	
2 - 3																	
3 - 4																	
4 - 5																	
5 - 6																	
6 - 7																	
7 - 8																	
8 - 9																	
9 - 10																	
10 - 11																	
11 - 12																	
PM HOURS																	
12 - 1																	
1 - 2																	
2 - 3																	
3 - 4	152		5	1		3.5	1	9	1	6.4		2	1.2	11.1		171	
4 - 5	183	1	6			3.5		6	2	4.0		2	1.0	8.5		200	
5 - 6	155		3			1.9		3	1	2.5				4.3		162	
6 - 7	118		4			3.1		7		5.4				8.5		129	
7 - 8	71		1			1.3		2	1	4.0				5.3		75	
8 - 9	82		3			3.5		1		1.2				4.7		86	
9 - 10	70			1		1.4								1.4	1	72	
10 - 11	25							3	1	13.8				13.8		29	
11 - 12	15							1	1	11.8				11.8		17	

AM TOTAL																	
PM TOTAL	871	1	22	2		2.7	1	32	7	4.3		4	.4	7.3	1	941	
DAY TOTAL	871	1	22	2		2.7	1	32	7	4.3		4	.4	7.3	1	941	
														2-AXLE EQUIVALENT		1015	

STATE OF WASHINGTON - DEPARTMENT OF TRANSPORTATION
 TRIP SYSTEM
 HOURLY TRAFFIC CLASSIFICATION SUMMARY

SR 014 MP 021.77 OFF SYSTEM ID. LEG DIRECTION OF TRAFFIC EASTBOUND LANE ALL OF
 COUNT IDENTIFIER HPMS COUNTER NUMBER 451954 DESCRIPTION: ON SR 14 AT CLARK/SKAMANIA CO LINE

11-01-16 TUESDAY		CARS PICKUPS	SINGLE UNITS				SINGLE UNIT %	DOUBLE UNITS			DOUBLE UNIT %	TRAINS			TRAIN %	TRUCK %	CLASS UNKNOWN	TOTAL VEHICLES
AM HOURS	BUS		MED	HVY	4+	4-		5	6+	5-		6	7+					
12 - 1		11							1		8.3				8.3			12
1 - 2		3							1	1	20.0		1		20.0			5
2 - 3		3		1		12.5		1	1		25.0			2	25.0			8
3 - 4		11		1	1	13.3		1			6.7				20.0		1	15
4 - 5		16		2		9.5		1			4.8			1	4.8		1	21
5 - 6		48	1			1.8		4	1		8.8			2	3.5		1	57
6 - 7		95		4	6	8.9		1	4	1	5.4			1	.9			112
7 - 8		108		7	2	7.2		4	3		5.6			1	.8			125
8 - 9		109	2	1	1	3.2		1	7	4	9.5			1	.8			126
9 - 10		101		2	3	6.6		1	7	3	9.1			1	.8			121
10 - 11		90	1	5	2	7.6		1	8	9	15.1			2	1.7			119
11 - 12		109	1	8	4	9.4		4	8	4	11.5			1	.7			139
PM HOURS																		
12 - 1		115		4	1	3.7		3	9	3	11.0		1		.7			136
1 - 2		127	1	3	2	4.2		1	6		4.9			4	2.8			144
2 - 3		149		9	4	7.6		2	2	4	4.7			2	1.2			172
3 - 4		195	1	3	2	2.8			6	3	4.2			4	1.9			214
4 - 5		179		6	1	3.6			5	2	3.6			1	1.0		1	196
5 - 6		194		5		2.4			3	3	2.9			1	.5			206
6 - 7		136		4		2.8			2	1	2.1			1	.7			144
7 - 8		98		3		2.9		1	2		2.9			1	1.0			105
8 - 9		60		2		3.0			4		6.0			1	1.5			67
9 - 10		49		1		2.0									2.0			50
10 - 11		37							3	1	9.3				11.6		1	43
11 - 12		11		2		11.8			3	1	23.5			1	2.3			17
AM TOTAL		704	5	31	19	4	6.9	12	45	24	9.4	1		12	1.5		3	860
PM TOTAL		1350	2	42	10		3.6	7	45	18	4.7	1	2	15	1.2		2	1494
DAY TOTAL		2054	7	73	29	4	4.8	19	90	42	6.4	2	2	27	1.3		5	2354
																	2-AXLE EQUIVALENT	2685

STATE OF WASHINGTON - DEPARTMENT OF TRANSPORTATION
 TRIPS SYSTEM
 HOURLY TRAFFIC CLASSIFICATION SUMMARY

SR 014	MP 021.77	OFF SYSTEM ID.	LEG	DIRECTION OF TRAFFIC EASTBOUND	LANE ALL OF							
COUNT IDENTIFIER	HPMS	COUNTER NUMBER 451954	DESCRIPTION: ON SR 14 AT CLARK/SKAMANIA CO LINE									
11-02-16 WEDNESDAY												
AM HOURS	CARS PICKUPS	BUS	SINGLE MED	UNITS HVY 4+	SINGLE UNIT %	DOUBLE UNITS 4- 5 6+	DOUBLE UNIT %	TRAINS 5- 6 7+	TRAIN %	TRUCK %	CLASS UNKNOWN	TOTAL VEHICLES
12 - 1	19		1		4.8	1	4.8			9.5		21
1 - 2	5		1		12.5	1 1	25.0			37.5		8
2 - 3	5					3	37.5			37.5		8
3 - 4	7		1	1	22.2					22.2		9
4 - 5	15		1	2	13.0	3	13.0			34.8		23
5 - 6	51		1	1	3.3	4 2	9.8		2	3.3		61
6 - 7	98	1	9	3	10.9	6 2	6.7			17.6		119
7 - 8	134	1	7	1	5.9	2 5 3	6.5			12.4		153
8 - 9	133	1	11		7.6	1 3 5	5.7		2	1.3	1	157
9 - 10	101	1	3	3	5.6	2 11 2	12.1		1	.8		124
10 - 11	96			5	4.3	1 8 3	10.4		2	1.7		115
11 - 12	115	1	1	4	4.4	2 13	11.0			15.4		136
PM HOURS												
12 - 1	129		1	1	1.4	8 3	7.5		3	2.1	1	146
1 - 2	127	1	7	6	9.0	3 3 5	7.1		4	2.6		156
2 - 3	147		4	4	4.8	2 7 1	6.0		3	1.8		168
3 - 4	184	2	4	1	3.4	1 6 3	4.9		2	1.0		203
4 - 5	180		1	2	1.6	4 1	2.6		1	.5		189
5 - 6	207		5	1	2.7	3	1.4		1	.5	3	220
6 - 7	136		4		2.7	6 4	6.7			9.3		150
7 - 8	92		2		2.1	2 1	3.1			5.2		97
8 - 9	78		2		2.3	4 2 1	8.0			10.3		87
9 - 10	54		1		1.6	1 3 2	9.8			11.5		61
10 - 11	37		1		2.6					2.6		38
11 - 12	13	1			5.3	1 2	15.8		2	10.5		19

AM TOTAL	779	5	36	20	6.5	8 58 18	9.0		9	1.0	1	934
PM TOTAL	1384	4	32	15	3.3	12 46 21	5.1		16	1.0	4	1534
DAY TOTAL	2163	9	68	35	4.5	20 104 39	6.6		25	1.0	5	2468
											2-AXLE EQUIVALENT	2802

STATE OF WASHINGTON - DEPARTMENT OF TRANSPORTATION
 TRIPS SYSTEM
 HOURLY TRAFFIC CLASSIFICATION SUMMARY

SR 014	MP 021.77	OFF SYSTEM ID.	LEG	DIRECTION OF TRAFFIC	EASTBOUND	LANE ALL	OF					
COUNT IDENTIFIER	HPMS	COUNTER NUMBER	451954	DESCRIPTION: ON SR 14 AT CLARK/SKAMANIA CO LINE								
11-03-16												
THURSDAY												
AM HOURS	CARS PICKUPS	BUS	SINGLE MED	UNITS HVY 4+	SINGLE UNIT %	DOUBLE UNITS 4- 5 6+	DOUBLE UNIT %	TRAINS 5- 6 7+	TRAIN %	TRUCK %	CLASS UNKNOWN	TOTAL VEHICLES
12 - 1	13		1		6.7					6.7	1	15
1 - 2	10					1	9.1			9.1		11
2 - 3	5					1 2	37.5			37.5		8
3 - 4	7		1	1	22.2					22.2		9
4 - 5	12			2	12.5	1	6.3		1	6.3		16
5 - 6	51		1	1	3.2	5 2	11.3		2	3.2		62
6 - 7	107		7	6	9.8	1 7 2	7.6		2	1.5		132
7 - 8	138	2	6	2	6.1	4 7 2	8.0		2	1.2		163
8 - 9	134	2	6	4	7.1	4 13 6	13.6					169
9 - 10	143	1	9	3	7.5	2 9 7	10.3					174
10 - 11	160	1	3	1	2.6	6 13 7	13.5					192
11 - 12	160	2	8	4	7.1	3 11 8	11.2		1	.5		197
PM HOURS												
12 - 1	141		6	2	5.0	2 6 2	6.2		1	.6	1	161
1 - 2	152	1	8		5.1	3 7 3	7.3	1	2	1.7		177
2 - 3	163	1	4	4	4.9	1 7 2	5.4		3	1.6		185
3 - 4	201		4	1	2.3	2 8	4.6		1	.5		217
4 - 5	206		9	1	4.3	2 10 2	6.0		2	.9		232
5 - 6	175		6		3.2	1 4 1	3.2					187
6 - 7	140		6		3.9	5	3.3		1	.7		152
7 - 8	106					3 1	3.6					110
8 - 9	76					2	2.6					78
9 - 10	56					3	5.0				1	60
10 - 11	38		1		2.4	3	7.1					42
11 - 12	15					1 2	16.7					18
AM TOTAL	940	8	42	24	6.4	20 67 37	10.8		9	.8	1	1148
PM TOTAL	1469	2	44	8	3.3	11 59 13	5.1	1	10	.7	2	1619
DAY TOTAL	2409	10	86	32	4.6	31 126 50	7.5	1	19	.7	3	2767
											2-AXLE EQUIVALENT	3153

STATE OF WASHINGTON - DEPARTMENT OF TRANSPORTATION
 TRIP SYSTEM
 HOURLY TRAFFIC CLASSIFICATION SUMMARY

SR 014 MP 021.77 OFF SYSTEM ID. LEG DIRECTION OF TRAFFIC EASTBOUND LANE ALL OF
 COUNT IDENTIFIER HPMS COUNTER NUMBER 451954 DESCRIPTION: ON SR 14 AT CLARK/SKAMANIA CO LINE

FRIDAY AM HOURS	CARS PICKUPS	SINGLE UNITS				SINGLE UNIT %	DOUBLE UNITS			DOUBLE UNIT %	TRAINS			TRAIN %	TRUCK %	CLASS UNKNOWN	TOTAL VEHICLES
		BUS	MED	HVY	4+		4-	5	6+		5-	6	7+				
12 - 1	13		2			13.3								13.3			15
1 - 2	2															1	3
2 - 3	8						1	1	20.0					20.0			10
3 - 4	4		2			25.0		2	25.0					50.0			8
4 - 5	14			1		5.0		2	20.0			1	5.0	30.0			20
5 - 6	46		1	1		3.4	1	6	15.5			1	1.7	20.7			58
6 - 7	97		6	2		6.8	1	3	9.4					16.2	1		117
7 - 8	135	1	4			3.3	5	4	6.0					10.0			150
8 - 9	173	3	8	3		6.6	2	11	9.9			2	1.9	18.4			212
9 - 10	183	1	11	2		6.3	5	8	10.9			2		17.2			221
10 - 11																	
11 - 12																	
PM HOURS																	
12 - 1																	
1 - 2																	
2 - 3																	
3 - 4																	
4 - 5																	
5 - 6																	
6 - 7																	
7 - 8																	
8 - 9																	
9 - 10																	
10 - 11																	
11 - 12																	
AM TOTAL	675	5	34	9		5.9	15	36	31	10.1		2	5	.9	16.8	2	814
PM TOTAL																	
DAY TOTAL	675	5	34	9		5.9	15	36	31	10.1		2	5	.9	16.8	2	814
															2-AXLE EQUIVALENT		966

10-31-16 THRU 11-04-16

AVERAGE WEEKDAY CLASSIFICATION VOLUMES *****

AVG WEEKDAY VOLUME	CARS PICKUPS	SINGLE UNITS				SINGLE UNIT %	DOUBLE UNITS			DOUBLE UNIT %	TRAINS			TRAIN %	TRUCK %	CLASS UNKNOWN	TOTAL VEHICLES
		BUS	MED	HVY	4+		4-	5	6+		5-	6	7+				
2209		9	76	32	1	4.7	23	107	44	6.9	1	1	24	1.0	12.6	4	2530
														AWD 2-AXLE EQUIVALENT			2883

TOTAL HOURS FOR COUNT 91
 3 DAYS FACTOR GROUP P07
 AVG WEEKDAY VOL 2530 X SEASONAL ADJ. FACTOR 1.0700 = ESTIMATED AVG DAILY TRAFFIC 2707

STATE OF WASHINGTON - DEPARTMENT OF TRANSPORTATION
 T R I P S S Y S T E M
 HOURLY TRAFFIC CLASSIFICATION SUMMARY

SR 014 MP 021.77 OFF SYSTEM ID. LEG DIRECTION OF TRAFFIC BOTH WAYS LANE ALL OF
 COUNT IDENTIFIER HPMS COUNTER NUMBER 451954 DESCRIPTION: ON SR 14 AT CLARK/SKAMANIA CO LINE

10-31-16 MONDAY	CARS PICKUPS	SINGLE UNITS				SINGLE UNIT %	DOUBLE UNITS			DOUBLE UNIT %	TRAINS			TRAIN %	TRUCK %	CLASS UNKNOWN	TOTAL VEHICLES
AM HOURS		BUS	MED	HVY	4+		4-	5	6+		5-	6	7+				
12 - 1																	
1 - 2																	
2 - 3																	
3 - 4																	
4 - 5																	
5 - 6																	
6 - 7																	
7 - 8																	
8 - 9																	
9 - 10																	
10 - 11																	
11 - 12																	
PM HOURS																	
12 - 1																	
1 - 2																	
2 - 3																	
3 - 4	327	1	11	6		4.9	3	15	3	5.7		4	1.1	11.6		370	
4 - 5	378	1	17	1		4.5		10	12	5.2		3	.7	10.4		422	
5 - 6	334		13	2		4.2	1	3	3	2.0		2	.6	6.7		358	
6 - 7	221		11	1		5.0		9		3.7				8.7		242	
7 - 8	119		3			2.3		5	2	5.4		1	.8	8.5		130	
8 - 9	116		4			3.2	1	3	1	4.0				7.2		125	
9 - 10	98		1	1		1.9		4		3.8				5.7	1	105	
10 - 11	35		1			2.2		6	2	17.8	1		2.2	22.2		45	
11 - 12	19							3	2	20.8				20.8		24	

AM TOTAL																	
PM TOTAL	1647	2	61	11		4.1	5	58	25	4.8	1	10	.6	9.5	1	1821	
DAY TOTAL	1647	2	61	11		4.1	5	58	25	4.8	1	10	.6	9.5	1	1821	
														2-AXLE EQUIVALENT		1995	

STATE OF WASHINGTON - DEPARTMENT OF TRANSPORTATION
 TRIPS SYSTEM
 HOURLY TRAFFIC CLASSIFICATION SUMMARY

SR 014 MP 021.77 OFF SYSTEM ID. LEG DIRECTION OF TRAFFIC BOTH WAYS LANE ALL OF
 COUNT IDENTIFIER HPMS COUNTER NUMBER 451954 DESCRIPTION: ON SR 14 AT CLARK/SKAMANIA CO LINE

11-01-16		CARS PICKUPS	SINGLE UNITS				SINGLE UNIT %	DOUBLE UNITS			DOUBLE UNIT %	TRAINS			TRAIN %	TRUCK %	CLASS UNKNOWN	TOTAL VEHICLES
TUESDAY AM HOURS	BUS		MED	HVY	4+	4-		5	6+	5-		6	7+					
12 - 1	11							2	2	26.7					26.7		15	
1 - 2	8							1	2	23.1	1		1	15.4	38.5		13	
2 - 3	9		1			5.6		4	2	33.3			2	11.1	50.0		18	
3 - 4	16		1	1		9.5		2		9.5					19.0	1	21	
4 - 5	46		4			7.0		2	3	8.8			1	1.8	17.5	1	57	
5 - 6	129	1	6			4.8		5	3	5.4			2	1.4	11.6	1	147	
6 - 7	217		19	6		9.7	1	8	4	5.0			2	.8	15.5	1	258	
7 - 8	255	1	13	3		5.9	6	3	2	3.8			3	1.0	10.8	1	287	
8 - 9	242	3	5	2		3.7	1	7	8	5.9			2	.7	10.4		270	
9 - 10	192		11	3	3	7.3	3	10	9	9.4			2	.9	17.6		233	
10 - 11	193	2	9	6	1	7.4	3	14	14	12.7			2	.8	20.9		244	
11 - 12																		
PM HOURS																		
12 - 1	223	1	13	5		7.0	6	10	5	7.8	1		6	2.6	17.4		270	
1 - 2	261	4	17	5	1	8.7	2	6	7	4.8			9	2.9	16.3		312	
2 - 3	307	3	14	5		6.2	4	4	15	6.5			4	1.1	13.8		356	
3 - 4	360	1	15	7		5.6	1	9	11	5.1			7	1.7	12.4		411	
4 - 5	400		22	3		5.6		9	9	4.0		1	2	.7	10.3	1	447	
5 - 6	392		22			5.1		7	5	2.8			2	.5	8.4		428	
6 - 7	259		9			3.3		6	1	2.5			1	.4	6.2		276	
7 - 8	149		6			3.7	1	4	1	3.7			1	.6	8.0		162	
8 - 9	91		6			5.6		8		7.5		1	1	1.9	15.0		107	
9 - 10	73		5	1		7.1		2	2	4.8			1	1.2	13.1		84	
10 - 11	49		1			1.7		5	1	10.3			1	1.7	13.8	1	58	
11 - 12	21		3			10.3		3	1	13.8			1	3.4	27.6		29	
AM TOTAL	1318	7	69	21	4	6.5	14	58	49	7.7	1		17	1.2	15.4	5	1563	
PM TOTAL	2585	9	133	26	1	5.7	14	73	58	4.9	1	2	36	1.3	12.0	2	2940	
DAY TOTAL	3903	16	202	47	5	6.0	28	131	107	5.9	2	2	53	1.3	13.2	7	4503	
2-AXLE EQUIVALENT																		
5110																		

Count Low

STATE OF WASHINGTON - DEPARTMENT OF TRANSPORTATION
 TRIP SYSTEM
 HOURLY TRAFFIC CLASSIFICATION SUMMARY

SR 014 MP 021.77 OFF SYSTEM ID. LEG DIRECTION OF TRAFFIC BOTH WAYS LANE ALL OF
 COUNT IDENTIFIER HPMS COUNTER NUMBER 451954 DESCRIPTION: ON SR 14 AT CLARK/SKAMANIA CO LINE

11-02-16 WEDNESDAY AM HOURS	CARS PICKUPS	SINGLE UNITS				SINGLE UNIT %	DOUBLE UNITS			DOUBLE UNIT %	TRAINS			TRAIN %	TRUCK %	CLASS UNKNOWN	TOTAL VEHICLES	
		BUS	MED	HVY	4+		4-	5	6+		5-	6	7+					
12 - 1	24		1			3.7		2		7.4				11.1			27	
1 - 2	6		1			8.3		1	3	33.3			1	8.3			12	
2 - 3	9							5		35.7							14	
3 - 4	11		2	1		21.4											14	
4 - 5	49		3	2		8.1		4	2	9.7			2	3.2			62	
5 - 6	145		10	2		7.0		5	5	5.8		1	2	1.8		1	171	
6 - 7	208	1	23	3		10.8		7	7	5.6			1	.4			250	
7 - 8	280	2	15	2		6.0	3	8	6	5.4						1	317	
8 - 9	277	3	17	1		6.6	1	4	9	4.4			4	1.3		1	317	
9 - 10	193	2	10	4		6.8	3	14	9	11.0			2	.8			237	
10 - 11	204	1	10	5		6.5	2	11	9	9.0			3	1.2			245	
11 - 12	213	2	7	4		5.0	5	19	4	10.9			4	1.6			258	
PM HOURS																		
12 - 1	264	1	12	5		5.8	3	13	9	8.0			5	1.6		1	313	
1 - 2	270	1	16	8		7.6	5	8	14	8.2			9	2.7			331	
2 - 3	309		20	5		6.9	3	9	9	5.8			6	1.7			361	
3 - 4	359	4	23	2		7.0	1	10	8	4.6			4	1.0		1	412	
4 - 5	391	2	20	4		5.9	8	9	5	5.0			3	.7			442	
5 - 6	419		23	2		5.4	3	8	3	3.0			1	.2		4	463	
6 - 7	276		15			4.9	1	9	5	4.9			1	.3			307	
7 - 8	143		7			4.4	1	4	3	5.0						1	159	
8 - 9	100		5			4.2	4	7	2	11.0							118	
9 - 10	70		2			2.4	1	5	5	13.3							83	
10 - 11	50		1			1.8		1	3	7.1			1	1.8			56	
11 - 12	25	1				3.1	1	2	1	12.5			2	6.3			32	

AM TOTAL	1619	11	99	24		7.0	14	80	54	7.7		1	19	1.0		3	1924	
PM TOTAL	2676	9	144	26		5.8	31	85	67	5.9			32	1.0		7	3077	
DAY TOTAL	4295	20	243	50		6.3	45	165	121	6.6		1	51	1.0		10	5001	
																2-AXLE EQUIVALENT		5690

STATE OF WASHINGTON - DEPARTMENT OF TRANSPORTATION
 TRIP SYSTEM
 HOURLY TRAFFIC CLASSIFICATION SUMMARY

SR 014	MP 021.77	OFF SYSTEM ID.	LEG	DIRECTION OF TRAFFIC BOTH WAYS	LANE ALL	OF							
COUNT IDENTIFIER	HPMS	COUNTER NUMBER	451954	DESCRIPTION: ON SR 14 AT CLARK/SKAMANIA CO LINE									
11-03-16													
THURSDAY													
AM HOURS	CARS PICKUPS	SINGLE BUS	SINGLE MED	UNITS HVY	4+	SINGLE UNIT %	DOUBLE UNITS 4- 5 6+	DOUBLE UNIT %	5- TRAINS 6 7+	TRAIN %	TRUCK %	CLASS UNKNOWN	TOTAL VEHICLES
12 - 1	21		1			4.0		4.0			8.0	2	25
1 - 2	12							25.0			25.0		16
2 - 3	7							50.0			50.0		14
3 - 4	15		1	1		10.0		10.0		1	25.0		20
4 - 5	46		3	2		8.3	1	13.3		1	23.3		60
5 - 6	134		6	1		4.5		7.7		2	13.5	1	156
6 - 7	246		17	6		8.0	1	4.9		3	14.0		286
7 - 8	269	3	11	3		5.6	4	5.6		2	11.8		305
8 - 9	260	5	12	8		7.8	5	10.0		2	18.8		320
9 - 10	241	2	17	7		8.6	6	10.6	1	4	20.5		303
10 - 11	269	2	19	2		6.9	7	10.9		3	18.7		331
11 - 12	270	4	11	8		6.9	3	10.3		4	18.4		331
PM HOURS													
12 - 1	273	2	19	6		8.3	3	6.8		1	15.4	1	324
1 - 2	290	2	19	2		6.6	6	8.8		6	17.4		351
2 - 3	344	1	20	7	2	7.3	2	7.6	1	5	16.1		410
3 - 4	422	1	26	4	1	6.7	4	5.0		2	12.1		480
4 - 5	459	2	38	3		8.1	5	5.3		2	13.7	1	533
5 - 6	445	2	27	1		6.1	2	3.8			9.9		494
6 - 7	322		13	1		3.9	4	4.8		1	9.0	2	356
7 - 8	170		1			.6	1	5.0			5.6		180
8 - 9	107		1			.9	1	6.1			7.0		115
9 - 10	79	1	3			4.3	5	5.4		3	13.0	1	92
10 - 11	53		1			1.7	5	8.5			10.2		59
11 - 12	29						1	11.8		1	14.7		34
AM TOTAL	1790	16	98	38		7.0	27	9.2		1	17.3	3	2167
PM TOTAL	2993	11	168	24	3	6.0	28	5.9		1	12.5	5	3428
DAY TOTAL	4783	27	266	62	3	6.4	55	7.2		2	14.4	8	5595
											2-AXLE EQUIVALENT		6385

STATE OF WASHINGTON - DEPARTMENT OF TRANSPORTATION
 TRIP SYSTEM
 HOURLY TRAFFIC CLASSIFICATION SUMMARY

SR 014 MP 021.77 OFF SYSTEM ID. LEG DIRECTION OF TRAFFIC BOTH WAYS LANE ALL OF
 COUNT IDENTIFIER HPMS COUNTER NUMBER 451954 DESCRIPTION: ON SR 14 AT CLARK/SKAMANIA CO LINE

11-04-16 FRIDAY AM HOURS	CARS PICKUPS	BUS	SINGLE MED	UNITS HVY	4+	SINGLE UNIT %	DOUBLE UNITS 4- 5 6+	DOUBLE UNIT %	TRAINS 5- 6 7+	TRAIN %	TRUCK %	CLASS UNKNOWN	TOTAL VEHICLES
12 - 1	16		3			15.8					15.8		19
1 - 2	6						2	22.2			22.2	1	9
2 - 3	13			1		5.3	1 3 1	26.3			31.6		19
3 - 4	10		2			12.5	3 1	25.0			37.5		16
4 - 5	47		1	1		3.4	4 4	13.8		1	19.0		58
5 - 6	120		4	1		3.5	1 7 6	9.9		2	14.9		141
6 - 7	211		15	2		6.9	1 7 8	6.5		1	13.8	1	246
7 - 8	263		15			5.5	5 4 4	4.4		1	10.2		293
8 - 9	314		5 17	5		7.2	3 14 15	8.5		2 2	16.7		377
9 - 10	327		2 17	3		5.8	6 10 16	8.4		1	14.4		382
10 - 11													
11 - 12													
PM HOURS													
12 - 1													
1 - 2													
2 - 3													
3 - 4													
4 - 5													
5 - 6													
6 - 7													
7 - 8													
8 - 9													
9 - 10													
10 - 11													
11 - 12													
AM TOTAL	1327	8	74	13		6.1	17 54 55	8.1	2 8	.6	14.8	2	1560
PM TOTAL													
DAY TOTAL	1327	8	74	13		6.1	17 54 55	8.1	2 8	.6	14.8	2	1560
											2-AXLE EQUIVALENT		1799

10-31-16 THRU 11-04-16

AVERAGE WEEKDAY CLASSIFICATION VOLUMES *****

AVG WEEKDAY VOLUME	CARS PICKUPS	BUS	SINGLE MED	UNITS HVY	4+	SINGLE UNIT %	DOUBLE UNITS 4- 5 6+	DOUBLE UNIT %	TRAINS 5- 6 7+	TRAIN %	TRUCK %	CLASS UNKNOWN	TOTAL VEHICLES
4539		24	255	56	2	6.4	50 185 131	6.9	1 1 47	.9	14.2	9	5298
											AWD 2-AXLE EQUIVALENT		6041

TOTAL HOURS FOR COUNT 90
 2 DAYS FACTOR GROUP P07
 AVG WEEKDAY VOL 5298 X SEASONAL ADJ. FACTOR 1.0700 = ESTIMATED AVG DAILY TRAFFIC 5669

PEAK HOUR PERCENTAGES: K = 10.06 D = 56.47 T = 13.70
 PEAK HOUR LOCATION : VOLUME = 533 DATE: 11/03/16 TIME: 04:00 PM

NOTE: MED HIGH WB/COUNT HIGH?