



*RH*

Interval  60 min.  15 min.  
 Binned(CL/SP)  Count(volume)  
Lane No  1  2

---

Direction Channel 1 \_\_\_\_\_  
Direction Channel 2 \_\_\_\_\_  
Unique ID# \_\_\_\_\_

Counter No. 172298 Count ID HPMS  
SR 500 RRT/RRQ MP 19.29  
Leg 2 Direction SB OSID \_\_\_\_\_

Station Description ON SR-500 S/O NE 3rd ave / NE DALLAS ST

Date	Day	Time	Comments			
4/20/15	2	12:15	Manual (1) <u>3</u> (2) _____ Counter (1) <u>3</u> (2) _____	Set up ok	JDM/BJ	6.5v
4/21/15	3	07:54	Manual (1) <u>13</u> (2) _____ Counter (1) <u>13</u> (2) _____	Check ok	JDM/BJ	6.5v
4/22/15	4	07:35	Manual (1) <u>10</u> (2) _____ Counter (1) <u>10</u> (2) _____	Check ok	JDM/BJ	6.4v
4/23/15	5	07:45	Manual (1) <u>6</u> (2) _____ Counter (1) <u>6</u> (2) _____	Check ok	JDM/BJ	6.5v
4/24/15	6	06:33	Manual (1) _____ (2) _____ Counter (1) _____ (2) _____	P/U ok	JDM/BJ	6.4v

*Tube up*

Sketch

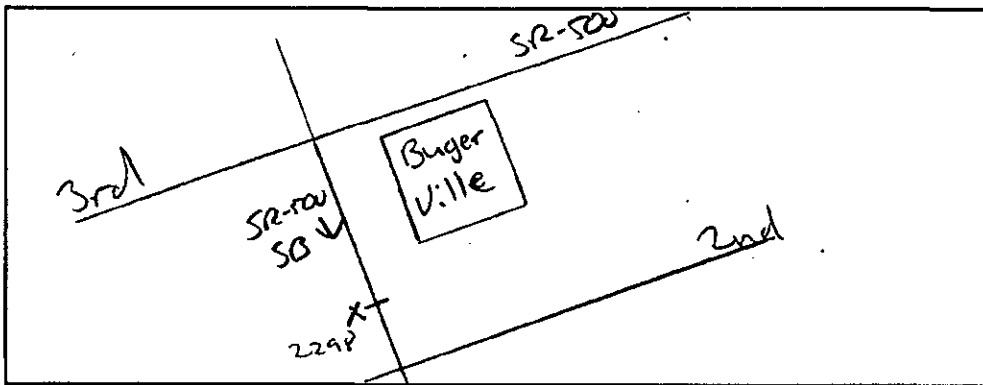

*J. Myller*  
Field Person



Washington State  
Department of Transportation

*Ru*

# Diamond Traffic Counter

Interval  60 min.  15 min.  
 Binned(CL/SP)  Count(volume)  
 Lane No  1  2

---

Direction Channel 1 \_\_\_\_\_  
 Direction Channel 2 \_\_\_\_\_  
 Unique ID# \_\_\_\_\_

Counter No. 178684 Count ID HPMS  
 SR 500 RRT/RRQ \_\_\_\_\_ MP 19.29  
 Leg 2 Direction NB OSID \_\_\_\_\_

Station Description ON SR-500 S/O NE 3rd ave / NE DALLAS ST

Date	Day	Time	Comments
4/20/15	2	12:17 <del>12:15</del>	Manual (1) 3 (2) _____ Set up ok JDM/BJ 6.5v Counter (1) 3 (2)
4/21/15	3	07:37	Manual (1) 9 (2) _____ Check ok JDM/BJ 6.5v Counter (1) 9 (2)
4/22/15	4	07:41	Manual (1) 4 (2) _____ Check ok JDM/BJ 6.5v Counter (1) 4 (2)
4/23/15	5	07:45	Manual (1) 9 (2) _____ Check ok JDM/BJ 6.4v Counter (1) 9 (2)
4/24/15	6	06:33	Manual (1) 1 (2) _____ P/U ok JDM/BJ 6.5v Counter (1) 1 (2)

Sketch

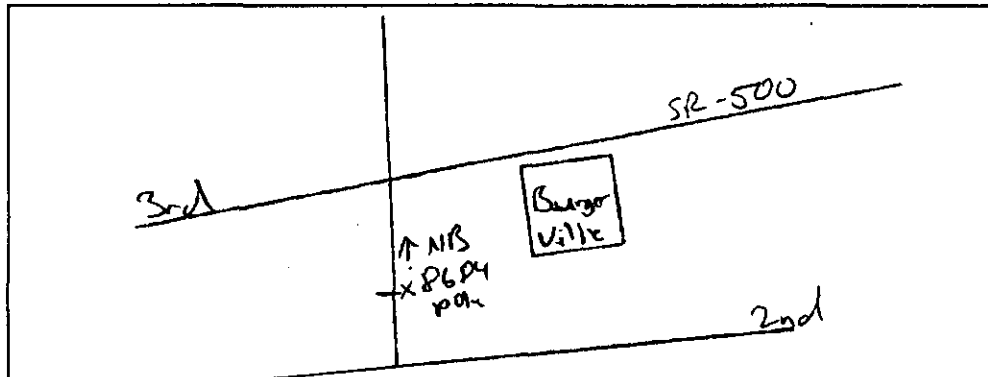

*J. Myddar*  
Field Person

SR 500 MP 019.29 OFF SYSTEM ID. LEG 2 DIRECTION OF TRAFFIC SOUTHBOUND LANE ALL OF

COUNT IDENTIFIER NPMS COUNTER NUMBER 172298 DESCRIPTION: ON SR 500 S/O NE 3RD AVE/NE DALLAS ST

04/20/15 MONDAY	AM HOURS	PM HOURS	AM PEAK HOUR 0000 TO 0000 VOLUME	PM PEAK HOUR 0330 TO 0430 VOLUME	AM TOTAL	PM TOTAL	DAILY TOTAL
12	1	2	1	2	3	4	7
1	2	3	2	3	5	6	11
..	..	..	..	..	..	..	..
..	..	..	..	..	..	..	..
00-15	..	..	..	..	..	..	..
15-30	..	..	..	..	..	..	..
30-45	..	..	..	..	..	..	..
45-00	..	..	..	..	..	..	..
HOUR	..	..	..	..	..	..	..
TOT	..	..	75	132	148	179	1237

04/21/15 TUESDAY

AM HOURS	PM HOURS	AM PEAK HOUR 0900 TO 1000 VOLUME	PM PEAK HOUR 0415 TO 0515 VOLUME	AM TOTAL	PM TOTAL	DAILY TOTAL
12	1	2	3	4	5	6
1	2	3	4	5	6	7
..	..	..	..	..	..	..
..	..	..	..	..	..	..
00-15	..	..	..	..	..	..
15-30	..	..	..	..	..	..
30-45	..	..	..	..	..	..
45-00	..	..	..	..	..	..
HOUR	..	..	..	..	..	..
TOT	4	5	84	132	146	191

04/22/15 WEDNESDAY

AM HOURS	PM HOURS	AM PEAK HOUR 0900 TO 1000 VOLUME	PM PEAK HOUR 0230 TO 0330 VOLUME	AM TOTAL	PM TOTAL	DAILY TOTAL
12	1	2	3	4	5	6
1	2	3	4	5	6	7
..	..	..	..	..	..	..
..	..	..	..	..	..	..
00-15	..	..	..	..	..	..
15-30	..	..	..	..	..	..
30-45	..	..	..	..	..	..
45-00	..	..	..	..	..	..
HOUR	..	..	..	..	..	..
TOT	7	12	96	127	161	201





DOT-RNB515A-B

STATE OF WASHINGTON - DEPARTMENT OF TRANSPORTATION  
TRIP SYSTEM  
15 MINUTE TRAFFIC COUNT SUMMARY

DATE 04/29/15  
TIME 10:24:30  
PAGE 20

SR 500 MP 019.29 OFF SYSTEM ID. LEG 2 DIRECTION OF TRAFFIC NORTHBOUND LANE ALL OF  
COUNT IDENTIFIER HPMS COUNTER NUMBER 178684 DESCRIPTION: ON SR 500 S/O NE 3RD AVE/NE DALLAS ST

04/23/15 THURSDAY	AM HOURS												PM HOURS												DAILY TOTAL
	1	2	3	4	5	6	7	8	9	10	11	12	1	2	3	4	5	6	7	8	9	10	11	12	
12	1	2	3	4	5	6	7	8	9	10	11	12	1	2	3	4	5	6	7	8	9	10	11	12	838
1	2	3	4	5	6	7	8	9	10	11	12	1	2	3	4	5	6	7	8	9	10	11	12	1524	
00-15	4	1	1	1	4	10	45	19	19	45	35	44	34	33	64	44	59	48	26	14	20	4	15		
15-30	1	3	1	3	6	18	31	37	31	29	38	39	34	35	67	59	47	37	24	11	7	14	9		
30-45	2	2	1	2	9	17	21	38	32	42	37	31	32	69	57	73	36	31	18	13	9	5	5		
45-00	2	2	1	4	5	21	42	40	45	45	48	61	34	57	53	43	46	27	15	12	4	3	1		
TOT	7	2	8	4	10	24	66	137	134	127	161	158	134	194	241	219	188	143	84	50	40	26	30	2362	
									AM PEAK HOUR 0945 TO 1045 VOLUME							161									
									PM PEAK HOUR 0230 TO 0330 VOLUME							257									

04/24/15 FRIDAY	AM HOURS												PM HOURS												DAILY TOTAL
	1	2	3	4	5	6	7	8	9	10	11	12	1	2	3	4	5	6	7	8	9	10	11	12	
12	1	2	3	4	5	6	7	8	9	10	11	12	1	2	3	4	5	6	7	8	9	10	11	12	87
1	2	3	4	5	6	7	8	9	10	11	12	1	2	3	4	5	6	7	8	9	10	11	12	0	
00-15	2	1	1	1	1	2	4	11																	
15-30	4	2	1	1	2	4	11																		
30-45	2	2	1	1	3	8	14																		
45-00	1	3	1	3	8	14	26																		
TOT	9	8	4	3	9	28	26																		87
									AM PEAK HOUR 0530 TO 0630 VOLUME																48
									PM PEAK HOUR 0000 TO 0000 VOLUME																0

04/20/15 THRU 04/24/15 TOTAL HOURS FOR COUNT 89

AVG WEEKDAY VOL 2458 X SEASONAL ADJ. FACTOR 0.9900 = 2433 X AXLE CORR FACTOR 0.9810 = ESTIMATED AVG DAILY TRAFFIC 2387

FACTOR GROUP CB-02  
FACTOR GROUP GR-B2

SR 500 MP 019.29 OFF SYSTEM ID. LEG 2 DIRECTION OF TRAFFIC BOTH WAYS LANE ALL OF

COUNT IDENTIFIER HPMS COUNTER NUMBER 178684 DESCRIPTION: ON SR 500 S/O NE 3RD AVE/NE DALLAS ST

04/20/15 MONDAY	AM HOURS	5	6	7	8	9	10	11	12	PM HOURS	1	2	3	4	5	6	7	8	9	10	11	12	DAILY TOTAL		
12	1	2	3	4	5	6	7	8	9	10	11	12	1	2	3	4	5	6	7	8	9	10	11	12	19
1	2	3	4	5	6	7	8	9	10	11	12	1	2	3	4	5	6	7	8	9	10	11	12	13	
00-15																								15	
15-30																								16	
30-45																								33	
45-00																								5	
TOT																								2911	

AM PEAK HOUR 0000 TO 0000 VOLUME 0  
 PM PEAK HOUR 0400 TO 0500 VOLUME 466  
 AM TOTAL 0  
 PM TOTAL 2911

04/21/15 TUESDAY	AM HOURS	5	6	7	8	9	10	11	12	PM HOURS	1	2	3	4	5	6	7	8	9	10	11	12	DAILY TOTAL		
12	1	2	3	4	5	6	7	8	9	10	11	12	1	2	3	4	5	6	7	8	9	10	11	12	26
1	2	3	4	5	6	7	8	9	10	11	12	1	2	3	4	5	6	7	8	9	10	11	12	18	
00-15																								22	
15-30																								19	
30-45																								22	
45-00																								3	
TOT																								4426	

AM PEAK HOUR 0915 TO 1015 VOLUME 304  
 PM PEAK HOUR 0430 TO 0530 VOLUME 409  
 AM TOTAL 1607  
 PM TOTAL 2819

04/22/15 WEDNESDAY	AM HOURS	5	6	7	8	9	10	11	12	PM HOURS	1	2	3	4	5	6	7	8	9	10	11	12	DAILY TOTAL		
12	1	2	3	4	5	6	7	8	9	10	11	12	1	2	3	4	5	6	7	8	9	10	11	12	23
1	2	3	4	5	6	7	8	9	10	11	12	1	2	3	4	5	6	7	8	9	10	11	12	18	
00-15																								23	
15-30																								4	
30-45																								9	
45-00																								6	
TOT																								4560	

AM PEAK HOUR 1045 TO 1145 VOLUME 289  
 PM PEAK HOUR 0245 TO 0345 VOLUME 437  
 AM TOTAL 1551  
 PM TOTAL 3009

SR 500 MP 019.29 OFF SYSTEM ID. LEG 2 DIRECTION OF TRAFFIC BOTH WAYS LANE ALL OF

COUNT IDENTIFIER HPMS COUNTER NUMBER 178684 DESCRIPTION: ON SR 500 S/O NE 3RD AVE/NE DALLAS ST

04/23/15 THURSDAY	AM HOURS												PM HOURS												DAILY TOTAL
	1	2	3	4	5	6	7	8	9	10	11	12	1	2	3	4	5	6	7	8	9	10	11	12	
12	1	2	3	4	5	6	7	8	9	10	11	12	1	2	3	4	5	6	7	8	9	10	11	12	1553
1	2	3	4	5	6	7	8	9	10	11	12	1	2	3	4	5	6	7	8	9	10	11	12	2684	
00-15	5	2	1	1	4	5	23	61	38	43	76	65	71	68	66	103	92	73	41	29	32	11	17	16	
15-30	5	1	2	4	4	5	52	61	59	52	58	65	73	75	100	85	68	59	37	28	18	34	16	8	
30-45	2	3	6	10	12	44	45	70	59	67	78	67	67	68	115	105	111	62	56	30	14	21	8	2	
45-00	3	2	2	15	19	53	71	67	80	70	88	94	94	63	96	92	87	64	52	35	20	10	2		
TOT	15	4	13	6	33	46	172	233	236	241	265	289	297	272	352	400	376	286	240	143	115	84	76	43	4237
									AM PEAK HOUR 1100 TO 1200 VOLUME	289											AM TOTAL	1553			
									PM PEAK HOUR 0230 TO 0330 VOLUME	414											PM TOTAL	2684			

04/24/15 FRIDAY	AM HOURS												PM HOURS												DAILY TOTAL
	1	2	3	4	5	6	7	8	9	10	11	12	1	2	3	4	5	6	7	8	9	10	11	12	
12	1	2	3	4	5	6	7	8	9	10	11	12	1	2	3	4	5	6	7	8	9	10	11	12	126
1	2	3	4	5	6	7	8	9	10	11	12	1	2	3	4	5	6	7	8	9	10	11	12	0	
00-15	5	3	1	1	3	7	11																		
15-30	9	4	1	1	5	8																			
30-45	5	3	1	1	6	18																			
45-00	2	4	5	2	11	8																			
TOT	21	14	9	5	25	41	11																	126	
									AM PEAK HOUR 0515 TO 0615 VOLUME	45											AM TOTAL	126			
									PM PEAK HOUR 0000 TO 0000 VOLUME	0											PM TOTAL	0			

04/20/15 THRU 04/24/15 TOTAL HOURS FOR COUNT 89  
 3 DAYS FACTOR GROUP CB-02 FACTOR 0.9900 = 4364 X AXLE CORR FACTOR 0.9810 = ESTIMATED AVG DAILY TRAFFIC 4281  
 AVG WEEKDAY VOL 4408 X SEASONAL ADJ. FACTOR 0.9900 = 4364  
 PEAK HOUR PERCENTAGES: K = 10.57 D = 60.09  
 PEAK HOUR LOCATION : VOLUME = 466 DATE: 04/20/15 TIME: 04:00 PM