

Roadway Survey Field Sheet

TS Project #	Map	Grid	Start Time	# Of Days
--------------	-----	------	------------	-----------

Location: NE 99TH S + NE 72ND AVE

Type Of Survey
 Volume
 Speed
 Classification

Start Date: 09/02/03

S M T W T F S

End Date: 09/04/03

S M T W T F S

Counters
4

Tubes
4

Location ID: _____

City: VANCOUVER

SITE EVALUATION	POSTED SPEED	DWELL TIME																														
Vehicles Crossing Tube Perpendicular <input checked="" type="checkbox"/> YES <input type="checkbox"/> NO <input type="checkbox"/> ??? Do You Anticipate Queing Across Tube <input type="checkbox"/> YES <input checked="" type="checkbox"/> NO <input type="checkbox"/> ??? Speed Greater Than 20 Miles / Hour <input checked="" type="checkbox"/> YES <input type="checkbox"/> NO <input type="checkbox"/> ??? Tube Crosses More Than 2 Lanes <input type="checkbox"/> YES <input checked="" type="checkbox"/> NO <input type="checkbox"/> ??? SPEED: High _____ Mph Low _____ Mph	<input type="checkbox"/> None <input type="checkbox"/> 40 Mph <input type="checkbox"/> 25 Mph <input checked="" type="checkbox"/> 45 Mph <input type="checkbox"/> 30 Mph <input type="checkbox"/> 50 Mph <input type="checkbox"/> 35 Mph <input type="checkbox"/> 55 Mph <input type="checkbox"/> Other: _____	<table border="1"> <tr> <th>LOWEST SPEED</th> <th colspan="5">HIGHEST SPEED</th> </tr> <tr> <th>MPH</th> <th>10-20</th> <th>15-30</th> <th>25-40</th> <th>35-45</th> <th>> 45</th> </tr> <tr> <td>Standing Queue</td> <td>200</td> <td>130</td> <td>100</td> <td>80</td> <td>40</td> </tr> <tr> <td>5 - 10 MPH</td> <td>130</td> <td>90</td> <td>70</td> <td>60</td> <td>40</td> </tr> <tr> <td>> 10 MPH</td> <td>100</td> <td>80</td> <td>60</td> <td>40</td> <td>40</td> </tr> </table> Use 2 Counters if Traffic Conditions are different in each direction.	LOWEST SPEED	HIGHEST SPEED					MPH	10-20	15-30	25-40	35-45	> 45	Standing Queue	200	130	100	80	40	5 - 10 MPH	130	90	70	60	40	> 10 MPH	100	80	60	40	40
LOWEST SPEED	HIGHEST SPEED																															
MPH	10-20	15-30	25-40	35-45	> 45																											
Standing Queue	200	130	100	80	40																											
5 - 10 MPH	130	90	70	60	40																											
> 10 MPH	100	80	60	40	40																											

AXLE STRIKE COUNT	SYSTEM DELAY LOGIC	SPEED Low Vol	VEHICLE SPEED / CLASSIFICATION
G M D A B	D	G M B	M B G L
<input type="checkbox"/> Tube equal length <input type="checkbox"/> Use proper spacing <input type="checkbox"/> One Lane only except Low Volume Speed Surveys ADT 2,000			

COUNTER / SET DOWN		
Type	<u>AMAX</u>	
No.		
Box		
Tube Length		
<input type="checkbox"/> Hammer Test		
CHECK	DATE	TIME
P F		
P F		
P F		
P F		
P F		
PICK-UP		
<input type="checkbox"/> Hammer Test		
Date:	Time:	
FILE NAMES		
<u>0472AN43</u>		
<u>0472AS38</u>		
<u>0499SW29</u>		
<u>0499SE52</u>		

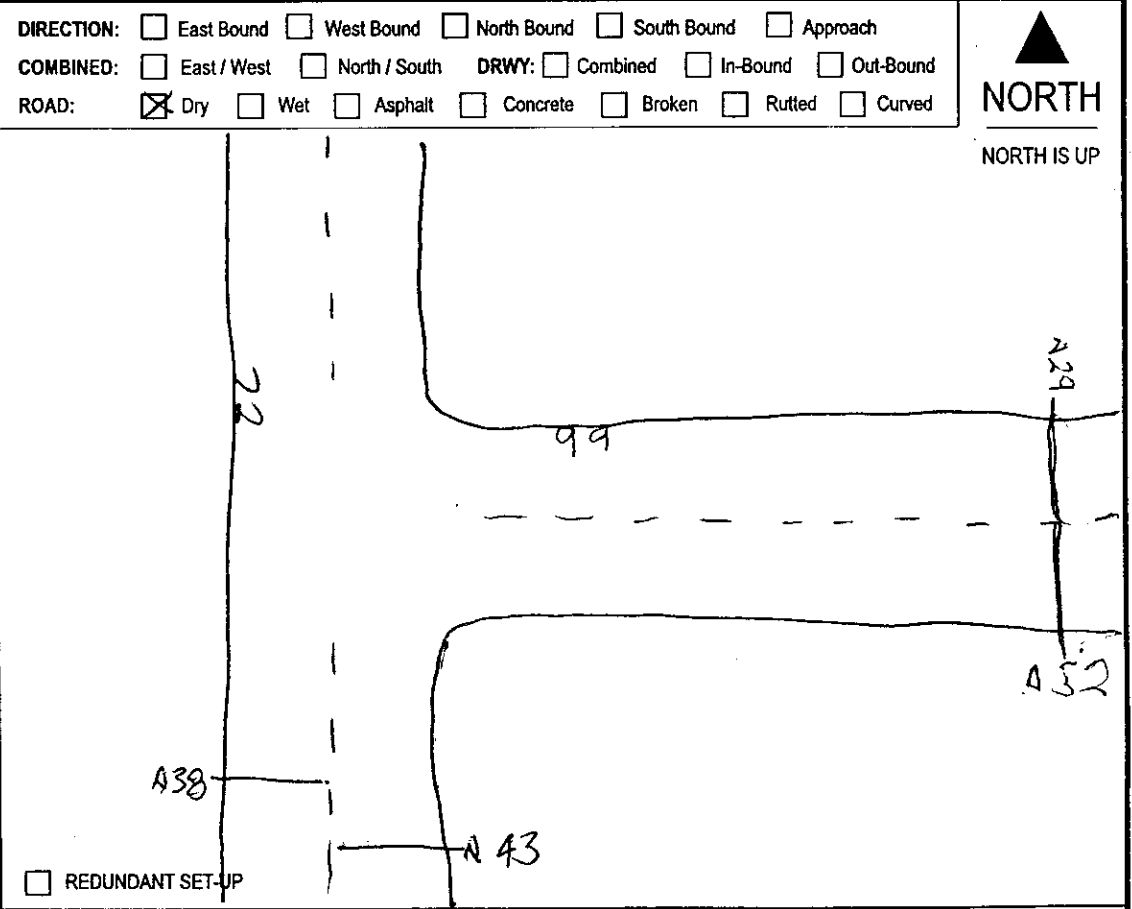

REDUNDANT SET-UP

Remarks: _____ WEATHER: Sunny Overcast Rain Snow

Surveyed By: M.P.

TRAFFIC SMITHY, Inc.
 1225 NW Murray Blvd. Suite 111
 Portland, OR 97229
 Phone: 503/641-6333 - Fax: 503/643-8866

TRAFFIC SMITHY, INC
 1225 NW MURRAY BLVD SUITE 111
 PORTLAND, OR 97229
 Phone: 503-641-6333 Fax: 503-643-8866

Roadway: NE 72ND AVENUE
 Location: SOUTH OF 99TH STREET

Date: 09/03/03
 Day of Week: Wednesday

SB Traffic

TIME	:00	:05	:10	:15	:20	:25	:30	:35	:40	:45	:50	:55	Total
00:00	0	4	4	2	1	0	1	1	1	3	2	0	19
01:00	1	0	4	1	2	1	2	1	0	0	0	1	13
02:00	0	2	2	0	1	0	0	1	3	0	4	2	15
03:00	0	0	2	1	0	4	4	1	2	3	2	4	23
04:00	3	1	4	4	1	5	7	7	13	5	3	6	59
05:00	5	10	11	12	18	20	19	23	19	31	19	20	207
06:00	23	26	31	32	45	42	42	51	64	71	59	53	539
07:00	58	55	40	60	53	72	63	66	65	42	49	59	682
08:00	51	48	32	42	50	30	46	43	47	36	34	25	484
09:00	33	29	29	29	33	40	24	27	34	36	33	24	371
10:00	34	36	28	26	23	38	23	29	39	32	29	27	364
11:00	41	32	26	41	38	29	28	42	36	37	30	31	411
12:00	41	25	30	20	36	25	27	26	23	38	24	20	335
13:00	39	28	20	28	30	22	35	30	23	25	34	28	342
14:00	26	28	18	25	24	35	24	30	32	32	29	28	331
15:00	25	19	26	24	28	50	31	27	27	41	32	34	364
16:00	38	28	28	36	44	25	31	24	33	31	23	19	360
17:00	39	22	28	29	39	39	31	35	31	38	26	32	389
18:00	24	26	29	27	40	18	25	29	29	25	23	22	317
19:00	20	20	34	19	10	22	19	16	18	23	18	19	238
20:00	12	17	12	13	12	14	21	15	16	22	13	12	179
21:00	9	20	11	16	12	10	11	5	6	9	11	6	126
22:00	10	10	5	6	10	5	11	3	2	7	2	0	71
23:00	5	2	0	3	4	2	4	4	4	4	1	3	36

Daily Total: 6275

AM Peak Hour: 715 (06:45 - 07:45)

11.3% Of Daily Total

PM Peak Hour: 416 (15:25 - 16:25)

6.62% Of Daily Total

4th Highest Hour: 411 (11:00 - 12:00)

6.54% Of Daily Total

8th Highest Hour: 364 (15:00 - 16:00)

5.80% Of Daily Total

TRAFFIC SMITHY, INC
 1225 NW MURRAY BLVD SUITE 111
 PORTLAND, OR 97229
 Phone: 503-641-6333 Fax: 503-643-8866

Roadway: NE 72ND AVENUE
 Location: SOUTH OF 99TH STREET

Date: 09/03/03
 Day of Week: Wednesday

NB Traffic

TIME	:00	:05	:10	:15	:20	:25	:30	:35	:40	:45	:50	:55	Total
00:00	7	6	9	4	4	3	5	6	4	0	2	2	52
01:00	5	5	4	4	2	3	6	2	1	1	4	2	39
02:00	2	2	1	0	2	4	2	1	3	0	0	1	18
03:00	2	0	2	0	2	0	3	0	0	1	1	1	12
04:00	1	3	0	1	1	1	1	0	2	2	1	2	15
05:00	2	7	1	0	4	1	4	4	6	6	5	10	50
06:00	3	6	10	8	9	11	12	11	12	13	21	15	131
07:00	19	18	19	14	21	28	17	24	28	25	27	16	256
08:00	16	23	20	17	29	22	15	25	16	27	22	31	263
09:00	16	17	20	19	19	18	17	23	14	16	14	22	215
10:00	21	22	20	31	33	30	19	33	23	19	19	25	295
11:00	32	24	22	31	28	23	27	35	34	38	38	33	365
12:00	34	31	34	40	38	24	22	35	29	22	46	36	391
13:00	49	46	43	49	39	39	26	36	26	40	29	48	470
14:00	41	28	46	45	35	40	24	34	43	57	27	27	447
15:00	45	49	36	63	50	36	44	57	47	57	49	68	601
16:00	52	43	43	67	59	56	70	68	80	83	57	53	731
17:00	69	84	77	84	66	62	50	64	74	69	67	59	825
18:00	49	57	56	58	47	47	56	46	55	42	37	41	591
19:00	36	37	37	24	36	39	27	39	34	25	24	25	383
20:00	28	39	33	38	39	24	34	35	29	26	26	26	377
21:00	30	23	22	25	19	23	29	20	15	20	19	16	261
22:00	15	9	15	15	12	11	8	15	16	8	12	10	146
23:00	23	11	10	5	9	5	5	12	8	9	9	5	111

Daily Total: 7045

AM Peak Hour: 365 (11:00 - 12:00)

5.18% Of Daily Total

PM Peak Hour: 853 (16:30 - 17:30)

12.1% Of Daily Total

4th Highest Hour: 591 (18:00 - 19:00)

8.38% Of Daily Total

8th Highest Hour: 383 (19:00 - 20:00)

5.43% Of Daily Total

TRAFFIC SMITHY, INC
 1225 NW MURRAY BLVD SUITE 111
 PORTLAND, OR 97229
 Phone: 503-641-6333 Fax: 503-643-8866

Roadway: NE 99TH STREET
 Location: EAST OF NE 72ND AVENUE

Date: 09/03/03
 Day of Week: Wednesday

WB Traffic

TIME	:00	:05	:10	:15	:20	:25	:30	:35	:40	:45	:50	:55	Total
00:00	1	0	1	0	0	0	0	1	0	0	0	0	3
01:00	0	0	3	0	0	0	0	0	0	0	0	0	3
02:00	0	0	1	0	0	0	0	0	0	0	1	0	2
03:00	0	0	0	0	0	1	0	0	0	0	0	0	1
04:00	0	0	1	0	0	0	0	0	0	3	0	0	4
05:00	2	1	1	0	2	2	2	0	0	2	3	5	20
06:00	3	3	3	2	4	4	3	4	1	6	4	4	41
07:00	7	6	2	11	7	6	3	4	4	4	3	6	63
08:00	4	11	4	4	3	2	4	2	5	3	2	3	47
09:00	6	4	2	3	5	4	5	2	3	6	1	1	42
10:00	3	3	1	4	2	5	4	4	3	8	3	2	42
11:00	7	4	3	7	8	3	4	3	3	2	1	4	49
12:00	6	5	5	3	1	8	1	0	2	2	1	3	37
13:00	6	2	4	5	1	1	1	3	2	2	3	2	32
14:00	0	3	2	2	1	3	5	3	4	5	6	3	37
15:00	0	5	2	1	1	2	7	3	2	6	1	5	35
16:00	6	4	3	2	2	2	3	0	3	2	1	8	36
17:00	1	1	5	3	3	5	9	2	4	6	7	4	50
18:00	0	5	5	1	3	3	0	1	3	5	4	3	33
19:00	4	1	3	1	1	1	2	4	3	5	2	1	28
20:00	0	3	2	1	2	2	1	2	2	1	1	1	18
21:00	2	2	1	3	1	1	2	0	1	0	1	0	14
22:00	1	2	0	1	3	2	3	0	1	2	0	0	15
23:00	1	2	0	0	0	4	0	3	1	0	0	1	12

Daily Total: 664

AM Peak Hour: 67 (07:15 - 08:15)

10.0% Of Daily Total

PM Peak Hour: 54 (16:55 - 17:55)

8.13% Of Daily Total

4th Highest Hour: 47 (08:00 - 09:00)

7.07% Of Daily Total

8th Highest Hour: 37 (12:00 - 13:00)

5.57% Of Daily Total

TRAFFIC SMITHY, INC
 1225 NW MURRAY BLVD SUITE 111
 PORTLAND, OR 97229
 Phone: 503-641-6333 Fax: 503-643-8866

Roadway: NE 99TH STREET
 Location: EAST OF 72ND AVENUE

Date: 09/03/03
 Day of Week: Wednesday

EB Traffic

TIME	:00	:05	:10	:15	:20	:25	:30	:35	:40	:45	:50	:55	Total
00:00	0	2	0	2	1	0	1	0	0	0	1	1	8
01:00	1	3	1	0	0	1	0	0	0	0	1	0	7
02:00	0	0	0	0	0	0	0	0	0	0	0	0	0
03:00	0	0	0	0	0	0	3	0	0	0	0	0	3
04:00	1	3	0	1	1	0	0	0	0	3	0	1	10
05:00	0	1	0	0	0	0	0	0	0	2	4	3	10
06:00	1	0	2	0	1	1	2	0	1	2	2	2	14
07:00	4	1	2	2	1	1	0	4	1	5	3	4	28
08:00	0	3	1	1	1	0	6	5	2	3	2	3	27
09:00	4	2	3	2	7	1	2	4	2	3	2	1	33
10:00	2	1	1	3	1	3	4	6	1	4	0	6	32
11:00	2	2	2	1	6	1	5	3	7	5	6	3	43
12:00	2	7	2	2	5	3	3	1	0	4	5	4	38
13:00	5	1	6	4	5	7	2	3	3	1	2	1	40
14:00	1	1	3	11	5	4	4	5	1	10	5	1	51
15:00	3	8	6	4	4	6	6	5	3	8	1	4	58
16:00	4	5	2	3	8	2	7	1	5	5	9	5	56
17:00	4	5	6	11	5	5	5	3	4	6	5	7	66
18:00	5	1	4	2	4	5	8	4	8	13	5	4	63
19:00	6	10	8	3	4	3	3	3	8	2	2	8	60
20:00	3	2	2	10	5	5	3	5	6	1	3	3	48
21:00	2	4	3	1	1	2	4	5	2	4	1	1	30
22:00	2	0	1	1	1	0	3	0	2	1	0	1	12
23:00	3	4	2	2	3	3	1	2	2	0	0	1	23

Daily Total: 760

AM Peak Hour: 46 (10:55 - 11:55)

6.05% Of Daily Total

PM Peak Hour: 78 (18:20 - 19:20)

10.2% Of Daily Total

4th Highest Hour: 58 (15:00 - 16:00)

7.63% Of Daily Total

8th Highest Hour: 43 (11:00 - 12:00)

5.65% Of Daily Total