



Interval  15 MIN  60 MIN  
 Count(volume)  Binned(CL/SP)  
 Speed Lane No  1  2

---

Direction CH #1 \_\_\_\_\_  
 Direction CH #2 \_\_\_\_\_  
 Data Hog # 3173

Counter No. 35-3541 Count ID HPMS  
 SR 501 RRT/RRQ \_\_\_\_\_ MP 0.61  
~~0.45~~  
 Leg 2 Direction WB OSID \_\_\_\_\_

Station Description ON SR-501 w/o COLUMBIA ST.  
ON SR 501 E/O FRANKLIN ST

Date	Day	Time	Comments
8-28-06	2	1136	Manual (1) <u>5</u> (2) _____ Counter (1) <u>5</u> (2) _____ Set up ok JDM/TWB 6.5
8-29-06	3	0733	Manual (1) <u>41</u> (2) _____ Counter (1) <u>41</u> (2) _____ Check ok JDM/TWB 6.4
8-30-06	4	0751	Manual (1) <u>40</u> (2) _____ Counter (1) <u>40</u> (2) _____ check ok JDM/TWB 6.4
8-31-06	5	1100	Manual (1) <u>45</u> (2) _____ SP=1 Counter (1) <u>44</u> (2) _____ Check ok JDM/TWB 6.4
9-1-06	6	0630	Manual (1) <u>2</u> (2) _____ Counter (1) <u>2</u> (2) _____ P/U ok JDM/TWB 6.4

Sketch

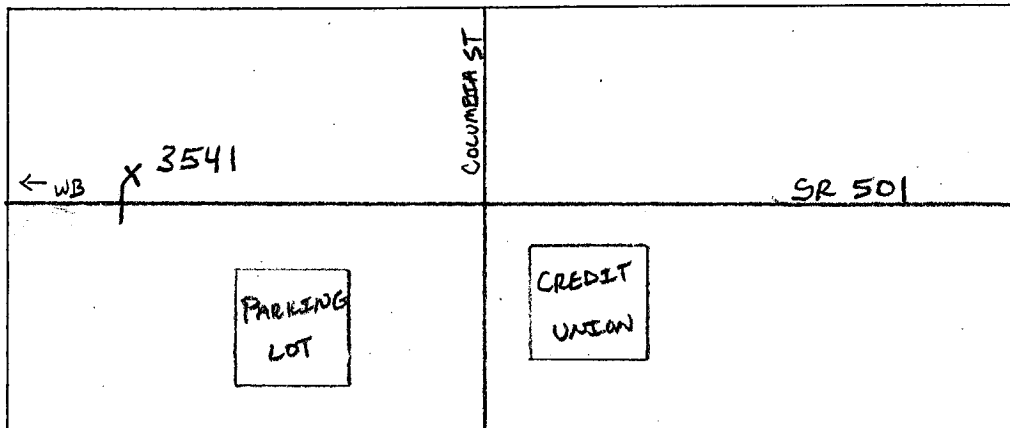

North

JDM/TWB  
 Field Person

SR 501 MP 000.61 OFF SYSTEM ID. LEG 1 DIRECTION OF TRAFFIC WESTBOUND LANE ALL OF

COUNT IDENTIFIER HPMS COUNTER NUMBER 353541 DESCRIPTION: ON SR 501 E/O FRANKLIN ST

08/28/06	MONDAY	AM HOURS												PM HOURS												DAILY TOTAL
		1	2	3	4	5	6	7	8	9	10	11	12	1	2	3	4	5	6	7	8	9	10	11	12	
12	1	2	3	4	5	6	7	8	9	10	11	12	1	2	3	4	5	6	7	8	9	10	11	12	135	
1	2	3	4	5	6	7	8	9	10	11	12	1	2	3	4	5	6	7	8	9	10	11	12	67		
TOT																									3874	

AM PEAK HOUR 0000 TO 0000 VOLUME 0  
PM PEAK HOUR 1215 TO 0115 VOLUME 664  
AM TOTAL 135  
PM TOTAL 3739

08/29/06	TUESDAY	AM HOURS												PM HOURS												DAILY TOTAL
		1	2	3	4	5	6	7	8	9	10	11	12	1	2	3	4	5	6	7	8	9	10	11	12	
12	1	2	3	4	5	6	7	8	9	10	11	12	1	2	3	4	5	6	7	8	9	10	11	12	7230	
1	2	3	4	5	6	7	8	9	10	11	12	1	2	3	4	5	6	7	8	9	10	11	12	68		
TOT																									3344	

AM PEAK HOUR 0745 TO 0845 VOLUME 574  
PM PEAK HOUR 1230 TO 0130 VOLUME 716  
AM TOTAL 3344  
PM TOTAL 3886

08/30/06	WEDNESDAY	AM HOURS												PM HOURS												DAILY TOTAL
		1	2	3	4	5	6	7	8	9	10	11	12	1	2	3	4	5	6	7	8	9	10	11	12	
12	1	2	3	4	5	6	7	8	9	10	11	12	1	2	3	4	5	6	7	8	9	10	11	12	7185	
1	2	3	4	5	6	7	8	9	10	11	12	1	2	3	4	5	6	7	8	9	10	11	12	79		
TOT																									3199	

AM PEAK HOUR 0745 TO 0845 VOLUME 524  
PM PEAK HOUR 1215 TO 0115 VOLUME 682  
AM TOTAL 3199  
PM TOTAL 3986

SR 501 MP 000.61 OFF SYSTEM ID. LEG 1 DIRECTION OF TRAFFIC WESTBOUND LANE ALL OF

COUNT IDENTIFIER HPMS COUNTER NUMBER 353541 DESCRIPTION: ON SR 501 E/O FRANKLIN ST

08/31/06 THURSDAY	AM HOURS												DAILY TOTAL													
	12	1	2	3	4	5	6	7	8	9	10	11														
12	1	2	3	4	5	6	7	8	9	10	11	12	85													
15	8	11	8	4	28	85	128	139	111	114	146	136	185	146	102	124	110	57	62	7	8	9	10	11	12	28
15-30	4	6	8	10	15	23	95	129	121	115	131	156	177	123	141	133	91	57	57	40	56	40	28	29	26	
30-45	13	11	13	5	15	54	132	141	115	118	143	126	161	140	107	93	91	50	55	50	44	44	34	26	15	
45-00	7	6	3	9	13	53	156	152	130	137	160	183	121	130	135	92	77	38	40	40	44	27	22	27		
TOT	39	31	35	32	47	158	419	545	585	477	484	580	601	644	539	485	442	369	212	203	161	134	105	85	7412	
									AM PEAK HOUR 0745 TO 0845 VOLUME 589													AM TOTAL 3432				
									PM PEAK HOUR 1245 TO 0145 VOLUME 706													PM TOTAL 3980				

09/01/06 FRIDAY	AM HOURS												DAILY TOTAL											
	12	1	2	3	4	5	6	7	8	9	10	11												
12	1	2	3	4	5	6	7	8	9	10	11	12	531											
15-30	9	9	4	6	5	14	22	28	28	59	85	85	85	85	85	85	85	85	85	85	85	85	85	85
30-45	13	11	10	15	8	22	59	85	85	85	85	85	85	85	85	85	85	85	85	85	85	85	85	85
45-00	5	10	6	8	17	61	61	61	61	61	61	61	61	61	61	61	61	61	61	61	61	61	61	61
TOT	46	40	24	37	58	156	170	170	170	170	170	170	170	170	170	170	170	170	170	170	170	170	170	170
									AM PEAK HOUR 0530 TO 0630 VOLUME 290													AM TOTAL 531		
									PM PEAK HOUR 0000 TO 0000 VOLUME 0													PM TOTAL 0		

08/28/06 THRU 09/01/06 TOTAL HOURS FOR COUNT 90  
 3 DAYS AVG WEEKDAY VOL 7276 X SEASONAL ADJ. FACTOR 0.9000 = 6548 X AXLE CORR FACTOR 0.8943 = ESTIMATED AVG DAILY TRAFFIC 5856  
 PEAK HOUR PERCENTAGES: K = 9.84 D = 100.00  
 PEAK HOUR LOCATION : VOLUME = 716 DATE: 08/29/06 TIME: 12:30 PM



Interval  15 MIN       60 MIN  
 Count(volume)       Binned(CL/SP)  
 Speed      Lane No  1  2

---

Direction CH #1 \_\_\_\_\_  
 Direction CH #2 \_\_\_\_\_  
 Data Hog # 3173

Counter No. 35-1694      Count ID HPMS  
 SR 501      RRT/RRQ \_\_\_\_\_      MP 0.45  
 Leg 1      Direction WB      OSID \_\_\_\_\_

Station Description ON SR-501 E/O COLUMBIA ST.

Date	Day	Time	Comments
8-28-06	2	1131	Manual (1) 7 (2) _____ Counter (1) 7 (2) _____ Set up OK JDM/TWB 6.3
8-29-06	3	0726	Manual (1) 32 (2) _____ SP=1 Counter (1) 31 (2) _____ Check OK JDM/TWB 6.3
8-30-06	4	0745	Manual (1) 50 (2) _____ SP=1 Counter (1) 49 (2) _____ Check OK JDM/TWB 6.3
8-31-06	5	1052	Manual (1) 50 (2) _____ SP=1 Counter (1) 49 (2) _____ Check OK JDM/TWB 6.3
9-1-06	6	0626	Manual (1) 1 (2) _____ Counter (1) 1 (2) _____ P/U OK JDM/TWB 6.3

Sketch

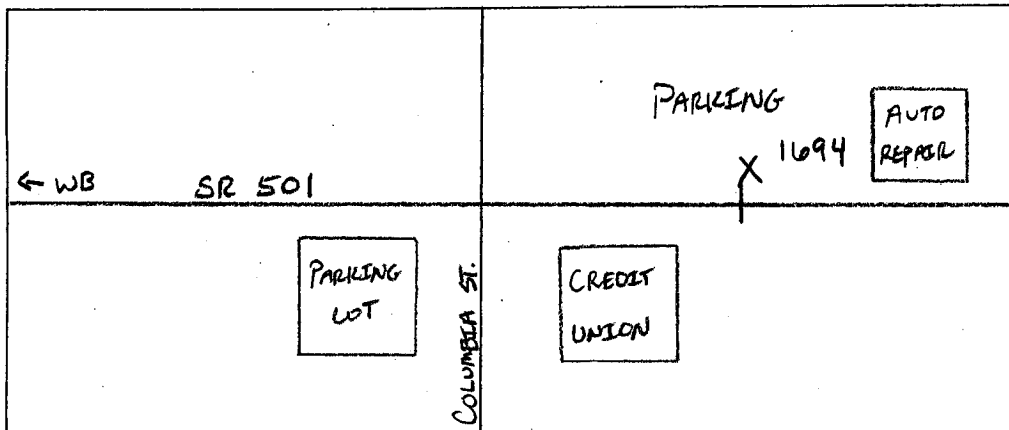

JDM/TWB  
Field Person

SR 501 MP 000.45 OFF SYSTEM ID. LEG 1 DIRECTION OF TRAFFIC WESTBOUND LANE ALL OF  
 COUNT IDENTIFIER HPMS COUNTER NUMBER 351694 DESCRIPTION: ON SR 501 E/O COLUMBIA ST

08/28/06	MONDAY	AM HOURS												PM HOURS												DAILY TOTAL
		1	2	3	4	5	6	7	8	9	10	11	12	1	2	3	4	5	6	7	8	9	10	11	12	
12	1	2	3	4	5	6	7	8	9	10	11	12	1	2	3	4	5	6	7	8	9	10	11	12	151	
1	2	3	4	5	6	7	8	9	10	11	12	1	2	3	4	5	6	7	8	9	10	11	12	151		
TOT																									4647	

AM PEAK HOUR 0000 TO 0000 VOLUME 0  
 PM PEAK HOUR 1215 TO 0115 VOLUME 799  
 AM TOTAL 151  
 PM TOTAL 4496

08/29/06	TUESDAY	AM HOURS												PM HOURS												DAILY TOTAL
		1	2	3	4	5	6	7	8	9	10	11	12	1	2	3	4	5	6	7	8	9	10	11	12	
12	1	2	3	4	5	6	7	8	9	10	11	12	1	2	3	4	5	6	7	8	9	10	11	12	8681	
1	2	3	4	5	6	7	8	9	10	11	12	1	2	3	4	5	6	7	8	9	10	11	12	8681		
00-15	12	8	2	6	15	21	89	168	181	122	154	157	166	237	194	173	130	103	73	47	54	33	20	14	3950	
15-30	9	10	12	6	10	43	113	121	180	112	156	171	151	204	158	151	128	114	59	56	47	33	29	14	4731	
30-45	8	5	13	6	20	63	154	148	140	130	142	153	216	164	172	136	133	86	60	49	47	30	29	12		
45-00	8	5	10	18	23	59	135	209	130	159	160	172	230	185	141	163	137	89	70	70	39	23	23	18		
TOT	37	28	37	38	68	186	491	646	631	523	612	653	763	790	665	623	528	392	262	222	187	119	107	73	8681	

AM PEAK HOUR 0730 TO 0830 VOLUME 718  
 PM PEAK HOUR 1230 TO 0130 VOLUME 887  
 AM TOTAL 3950  
 PM TOTAL 4731

08/30/06	WEDNESDAY	AM HOURS												PM HOURS												DAILY TOTAL
		1	2	3	4	5	6	7	8	9	10	11	12	1	2	3	4	5	6	7	8	9	10	11	12	
12	1	2	3	4	5	6	7	8	9	10	11	12	1	2	3	4	5	6	7	8	9	10	11	12	8630	
1	2	3	4	5	6	7	8	9	10	11	12	1	2	3	4	5	6	7	8	9	10	11	12	8630		
00-15	11	8	4	10	13	30	70	137	146	163	129	126	178	181	181	151	120	93	83	57	71	45	48	27	3800	
15-30	7	17	12	8	12	24	119	117	159	130	119	152	194	176	140	153	150	111	77	51	57	34	26	28	4830	
30-45	20	11	17	8	10	57	123	122	172	121	133	139	216	188	174	151	118	104	53	71	39	41	43	27		
45-00	20	11	6	12	19	96	158	197	162	167	140	156	219	166	145	171	120	96	85	49	36	44	29	13		
TOT	58	47	39	38	54	207	470	573	639	581	521	573	807	711	640	626	508	404	298	228	203	164	146	95	8630	

AM PEAK HOUR 0745 TO 0845 VOLUME 674  
 PM PEAK HOUR 1215 TO 0115 VOLUME 810  
 AM TOTAL 3800  
 PM TOTAL 4830

SR 501	MP 000.45	OFF SYSTEM ID.	LEG 1	DIRECTION OF TRAFFIC	WESTBOUND	LANE ALL OF
COUNT IDENTIFIER	HPMS	COUNTER NUMBER	351694	DESCRIPTION:	ON SR 501 E/O COLUMBIA ST	
08/31/06 THURSDAY						
		AM HOURS			PM HOURS	DAILY
		12	1	2	3	4
		1	2	3	4	5
		2	3	4	5	6
00-15	20	13	9	10	11	12
15-30	5	8	7	12	15	28
30-45	16	14	13	14	11	15
45-00	6	11	10	18	8	25
AM PEAK HOUR 0745 TO 0845 VOLUME	752					
PM PEAK HOUR 1245 TO 0145 VOLUME	823					
AM TOTAL	4105					
PM TOTAL	4728					
TOT	47	46	32	36	57	167

09/01/06 FRIDAY						
	AM HOURS			PM HOURS		DAILY
	1	2	3	4	5	TOTAL
	1	2	3	4	5	TOTAL
	2	3	4	5	6	TOTAL
00-15	14	13	7	7	18	89
15-30	13	11	6	15	9	28
30-45	18	11	4	8	28	58
45-00	9	9	8	9	20	63
AM PEAK HOUR 0515 TO 0615 VOLUME	238					
PM PEAK HOUR 0000 TO 0000 VOLUME	0					
AM TOTAL	480					
PM TOTAL	0					
TOT	54	44	25	39	62	167

08/28/06 THRU 09/01/06 TOTAL HOURS FOR COUNT 90  
 3 DAYS AVG WEEKDAY VOL 8715 X SEASONAL ADJ. FACTOR 0.9000 = 7844 X AXLE CORR FACTOR 0.8943 = ESTIMATED AVG DAILY TRAFFIC 7015  
 PEAK HOUR PERCENTAGES: K = 10.18 D = 100.00  
 PEAK HOUR LOCATION: VOLUME = 887 DATE: 08/29/06 TIME: 12:30 PM

NOTE: FACTORS QUESTIONABLE ?