

Interval  15 MIN       60 MIN  
 Count(volume)       Binned(CL/SP)  
 Speed      Lane No  1  2

---

Direction CH #1 BW  
 Direction CH #2 SB  
 Data Hog # 7061

Counter No. 35-3509      Count ID HAMS  
Recount  
 SR 500 RRT/RRQ \_\_\_\_\_      MP 18.75  
 Leg 1      Direction Sec 1-2      OSID \_\_\_\_\_

Station Description \_ ON SR500 N/O NE 15<sup>th</sup> Avenue

Date	Day	Time	Comments
8/28/16	2	1233	Manual (1) 8 (2) 4 Counter (1) 8 (2) 4 <i>Set o.k. JM 6.4</i>
8/29	3	0758	Manual (1) 46 (2) 26 Counter (1) 46 (2) 26 <i>check o.k. JM 6.4</i>
8/30	4	0841	Manual (1) 43 (2) 23 Counter (1) 43 (2) 23 <i>check o.k. JM 6.4</i>
8/31	5	1205	Manual (1) 44 (2) 21 Counter (1) 44 (2) 21 <i>check o.k. JM 6.4</i>
9/1	6	0708	Manual (1) 5 (2) 3 Counter (1) 5 (2) 3 <i>P/V JM 6.4</i>

Sketch

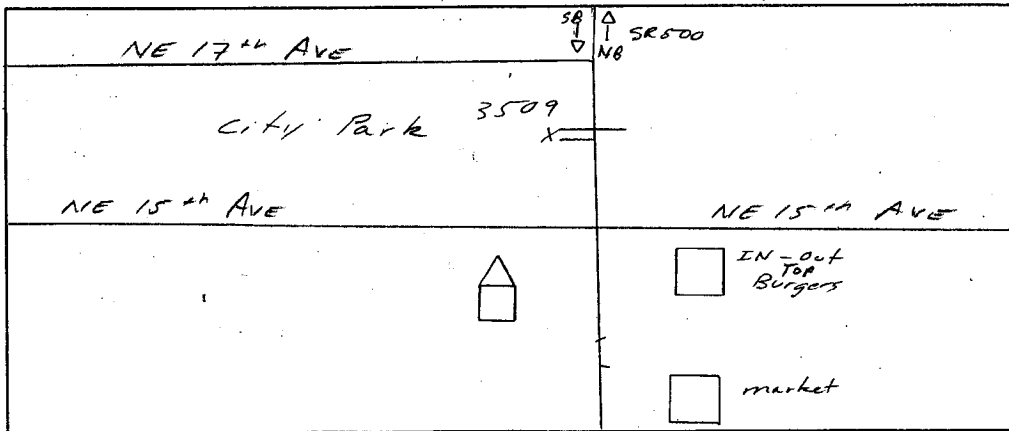

J. Mills  
Field Person

SR 500 MP 018.75 OFF SYSTEM ID. LEG 1 DIRECTION OF TRAFFIC SOUTHBOUND LANE ALL OF

COUNT IDENTIFIER HPMS COUNTER NUMBER 353509 DESCRIPTION: ON SR 500 N/O NE 15TH AVE

08/28/06	MONDAY	AM HOURS												PM HOURS												DAILY TOTAL	
COUNT	12	1	2	3	4	5	6	7	8	9	10	11	12	1	2	3	4	5	6	7	8	9	10	11	12	TOTAL	
00-15																											
15-30																											
30-45																											
45-00																											
TOT	12	1	2	3	4	5	6	7	8	9	10	11	12	1	2	3	4	5	6	7	8	9	10	11	12	2850	

AM PEAK HOUR 0000 TO 0000 VOLUME 0  
PM PEAK HOUR 0500 TO 0600 VOLUME 442  
AM TOTAL 2850  
PM TOTAL 0

08/29/06	TUESDAY	AM HOURS												PM HOURS												DAILY TOTAL	
COUNT	12	1	2	3	4	5	6	7	8	9	10	11	12	1	2	3	4	5	6	7	8	9	10	11	12	TOTAL	
00-15																											
15-30																											
30-45																											
45-00																											
TOT	19	8	7	11	22	119	248	287	338	300	341	368	451	343	425	374	440	430	395	296	162	98	71	31	5584		

AM PEAK HOUR 1100 TO 1200 VOLUME 368  
PM PEAK HOUR 0445 TO 0545 VOLUME 457  
AM TOTAL 2068  
PM TOTAL 3516

08/30/06	WEDNESDAY	AM HOURS												PM HOURS												DAILY TOTAL	
COUNT	12	1	2	3	4	5	6	7	8	9	10	11	12	1	2	3	4	5	6	7	8	9	10	11	12	TOTAL	
00-15																											
15-30																											
30-45																											
45-00																											
TOT	19	14	10	9	22	112	256	287	275	302	284	333	370	328	376	378	400	416	328	235	205	124	79	31	5193		

AM PEAK HOUR 1100 TO 1200 VOLUME 333  
PM PEAK HOUR 0445 TO 0545 VOLUME 434  
AM TOTAL 1923  
PM TOTAL 3270

SR 500 MP 018.75 OFF SYSTEM ID. LEG 1 DIRECTION OF TRAFFIC SOUTHBOUND LANE ALL OF

COUNT IDENTIFIER HPMS COUNTER NUMBER 353509 DESCRIPTION: ON SR 500 N/O NE 15TH AVE

HOUR	AM HOURS												PM HOURS												DAILY TOTAL
	12	1	2	3	4	5	6	7	8	9	10	11	12	1	2	3	4	5	6	7	8	9	10	11	
08/31/06 THURSDAY	12	1	2	3	4	5	6	7	8	9	10	11	12	1	2	3	4	5	6	7	8	9	10	11	5610
TOT	36	17	11	10	31	114	278	269	298	277	297	382	401	379	362	424	407	472	387	317	230	102	80	29	
	AM PEAK HOUR 1045 TO 1145 VOLUME 387												PM PEAK HOUR 0445 TO 0545 VOLUME 477												AM TOTAL 2020
	PM PEAK HOUR 0600 TO 0700 VOLUME 227												PM PEAK HOUR 0000 TO 0000 VOLUME 0												PM TOTAL 3590

HOUR	AM HOURS												PM HOURS												DAILY TOTAL
	12	1	2	3	4	5	6	7	8	9	10	11	12	1	2	3	4	5	6	7	8	9	10	11	
09/01/06 FRIDAY	12	1	2	3	4	5	6	7	8	9	10	11	12	1	2	3	4	5	6	7	8	9	10	11	410
TOT	18	14	12	6	30	103	227																		
	AM PEAK HOUR 0600 TO 0700 VOLUME 227												PM PEAK HOUR 0000 TO 0000 VOLUME 0												AM TOTAL 410
	PM PEAK HOUR 0000 TO 0000 VOLUME 0												PM PEAK HOUR 0600 TO 0700 VOLUME 227												PM TOTAL 0

08/28/06 THRU 09/01/06 90  
 TOTAL HOURS FOR COUNT  
 3 DAYS  
 AVG WEEKDAY VOL 5462 X SEASONAL ADJ. FACTOR 0.8600 = 4697 X AXLE CORR FACTOR 0.9465 = ESTIMATED AVG DAILY TRAFFIC 4446

08/28/06	MONDAY	AM HOURS	PM HOURS	TOTAL
00-15	12	1	2	3
15-30	1	3	4	7
30-45	2	4	5	9
45-00	3	5	6	11
TOT	12	10	11	2906
				0
				2906

08/29/06	TUESDAY	AM HOURS	PM HOURS	TOTAL
00-15	12	1	2	3
15-30	1	3	4	7
30-45	2	4	5	9
45-00	3	5	6	11
TOT	12	10	11	2906
				0
				2906

08/30/06	WEDNESDAY	AM HOURS	PM HOURS	TOTAL
00-15	12	1	2	3
15-30	1	3	4	7
30-45	2	4	5	9
45-00	3	5	6	11
TOT	12	10	11	2906
				0
				2906

AM PEAK HOUR 1100 TO 1200 VOLUME 271  
 PM PEAK HOUR 0500 TO 0600 VOLUME 481  
 AM TOTAL 1278  
 PM TOTAL 3285

SR 500 MP 018.75 OFF SYSTEM ID. LEG 1 DIRECTION OF TRAFFIC NORTHBOUND LANE ALL OF

COUNT IDENTIFIER HPMS COUNTER NUMBER 353509 DESCRIPTION: ON SR 500 N/O NE 15TH AVE

08/31/06	THURSDAY	AM HOURS												PM HOURS												DAILY TOTAL
COUNT	IDENTIFIER	1	2	3	4	5	6	7	8	9	10	11	12	1	2	3	4	5	6	7	8	9	10	11	12	TOTAL
12	1	2	3	4	5	6	7	8	9	10	11	12	1	2	3	4	5	6	7	8	9	10	11	12	194	
4	4	1	5	2	8	9	49	57	63	53	62	69	89	78	93	126	155	115	115	75	61	33	19	18	18	
7	4	5	1	1	9	21	43	47	40	51	69	98	68	80	88	91	122	103	59	58	39	13	19	19	19	
6	3	3	1	6	16	26	51	63	71	61	89	106	73	97	101	133	109	87	60	39	22	12	11	11	11	
11	4	2	3	5	17	43	58	61	56	69	82	94	88	103	125	122	115	71	60	53	30	20	10	10	10	
TOT	28	15	11	10	50	99	201	228	230	234	302	367	318	358	407	472	501	376	254	211	124	64	58	58	4932	

AM PEAK HOUR 1100 TO 1200 VOLUME 302  
PM PEAK HOUR 0430 TO 0530 VOLUME 532

AM TOTAL 1422  
PM TOTAL 3510

09/01/06	FRIDAY	AM HOURS												PM HOURS												DAILY TOTAL
COUNT	IDENTIFIER	1	2	3	4	5	6	7	8	9	10	11	12	1	2	3	4	5	6	7	8	9	10	11	12	TOTAL
12	1	2	3	4	5	6	7	8	9	10	11	12	1	2	3	4	5	6	7	8	9	10	11	12	194	
4	4	2	7	3	2	2	9	10	16	10	16	9	16	10	16	9	16	10	16	10	16	9	16	10	16	194
5	5	2	2	2	2	2	2	2	2	2	2	2	2	2	2	2	2	2	2	2	2	2	2	2	2	2
7	7	6	2	6	6	11	23	23	11	11	23	23	11	11	23	23	11	11	23	23	11	11	23	23	23	23
4	4	5	3	4	6	13	35	35	6	6	13	35	35	6	6	13	35	35	6	6	13	35	35	6	6	6
TOT	20	18	12	15	36	83	83	83	83	83	83	83	83	83	83	83	83	83	83	83	83	83	83	83	83	194

AM PEAK HOUR 0600 TO 0700 VOLUME 83  
PM PEAK HOUR 0000 TO 0000 VOLUME 0

AM TOTAL 194  
PM TOTAL 0

08/28/06 THRU 09/01/06  
TOTAL HOURS FOR COUNT 90

3 DAYS AVG WEEKDAY VOL 4789 X SEASONAL ADJ. FACTOR 0.8600 = 4119 X AXLE CORR FACTOR 0.9465 = ESTIMATED AVG DAILY TRAFFIC 3899

FACTOR GROUP GR-05

FACTOR GROUP GR-A2

08/28/06	MONDAY	AM HOURS												PM HOURS												DAILY TOTAL			
COUNT	IDENTIFIER	HPMS	COUNTER NUMBER	353509	DESCRIPTION: ON SR 500 N/O NE 15TH AVE																								
12	1	2	3	4	5	6	7	8	9	10	11	12	1	2	3	4	5	6	7	8	9	10	11	12					
1	2	3	4	5	6	7	8	9	10	11	12	1	2	3	4	5	6	7	8	9	10	11	12						
TOT																									5756				

08/29/06	TUESDAY	AM HOURS												PM HOURS												DAILY TOTAL			
COUNT	IDENTIFIER	HPMS	COUNTER NUMBER	353509	DESCRIPTION: ON SR 500 N/O NE 15TH AVE																								
12	1	2	3	4	5	6	7	8	9	10	11	12	1	2	3	4	5	6	7	8	9	10	11	12					
1	2	3	4	5	6	7	8	9	10	11	12	1	2	3	4	5	6	7	8	9	10	11	12						
TOT																									10455				

08/30/06	WEDNESDAY	AM HOURS												PM HOURS												DAILY TOTAL			
COUNT	IDENTIFIER	HPMS	COUNTER NUMBER	353509	DESCRIPTION: ON SR 500 N/O NE 15TH AVE																								
12	1	2	3	4	5	6	7	8	9	10	11	12	1	2	3	4	5	6	7	8	9	10	11	12					
1	2	3	4	5	6	7	8	9	10	11	12	1	2	3	4	5	6	7	8	9	10	11	12						
TOT																									9756				

00-15	15-30	30-45	45-00	HOUR	TOT	AM PEAK HOUR 1100 TO 1200 VOLUME	604	PM PEAK HOUR 0445 TO 0545 VOLUME	906	AM TOTAL	3201	PM TOTAL	6555
13	17	9	4	43	30	483	604	479	906	266	3201	154	6555

SR 500 MP 018.75 OFF SYSTEM ID. LEG 1 DIRECTION OF TRAFFIC BOTH WAYS LANE ALL OF

COUNT IDENTIFIER HPMS COUNTER NUMBER 353509 DESCRIPTION: ON SR 500 N/O NE 15TH AVE

08/31/06 THURSDAY	AM HOURS												DAILY TOTAL		
	1	2	3	4	5	6	7	8	9	10	11	12			
12	1	2	3	4	5	6	7	8	9	10	11	12	67	43	31
1	2	3	4	5	6	7	8	9	10	11	12	69	36	26	
17	9	6	3	3	4	4	1	13	46	110	131	144	80	42	32
30-45	11	7	8	1	13	46	110	131	144	131	132	136	91	48	33
45-00	17	7	3	9	19	59	118	132	136	134	154	162	231	219	159
TOT	64	32	22	20	45	164	377	470	526	507	531	684	831	879	973
													763	571	441
													226	144	87
													10542		

09/01/06 FRIDAY	AM HOURS												DAILY TOTAL		
	1	2	3	4	5	6	7	8	9	10	11	12			
12	1	2	3	4	5	6	7	8	9	10	11	12	52	52	52
1	2	3	4	5	6	7	8	9	10	11	12	82	82	82	
00-15	11	9	11	4	7	23	52	82	110	131	132	136	91	85	85
15-30	7	8	3	3	5	34	82	110	131	132	136	136	263	231	219
30-45	14	9	4	8	10	32	85	110	131	132	136	136	231	219	159
45-00	6	6	6	6	18	50	91	110	131	132	136	136	231	219	159
TOT	38	32	24	21	40	139	310	470	526	507	531	684	831	879	973
													763	571	441
													226	144	87
													10542		

08/28/06 THRU 09/01/06 TOTAL HOURS FOR COUNT 90

3 DAYS AVG WEEKDAY VOL 10251 X SEASONAL ADJ. FACTOR 0.8600 = 8816 X AXLE CORR FACTOR 0.9465 = ESTIMATED AVG DAILY TRAFFIC 8344

PEAK HOUR PERCENTAGES: K = 9.73 D = 53.36  
 PEAK HOUR LOCATION : VOLUME = 997 DATE: 08/31/06 TIME: 04:30 PM

AM PEAK HOUR 0600 TO 0700 VOLUME 310  
 PM PEAK HOUR 0000 TO 0000 VOLUME 0  
 AM TOTAL 604  
 PM TOTAL 0



Interval  15 MIN     60 MIN  
 Count(volume)     Binned(CL/SP)  
 Speed    Lane No  1     2

---

Direction CH #1 BW  
 Direction CH #2 SB  
 Data Hog # 7061

Counter No. 55-5550    Count ID HAMS Recount  
 SR 500    RRT/RRQ \_\_\_\_\_    MP 18.75  
 Leg 2    Direction See 1-2    OSID \_\_\_\_\_

Station Description - ON SR500 S/O NE 15th Avenue

Date	Day	Time	Comments
8/28/06	2	1244	Manual (1) 10 (2) 9 Counter (1) 10 (2) 9 Set o.k. JM 6.4
8/29	3	0753	Manual (1) 33 (2) 13 Counter (1) 33 (2) 13 check o.k. JM 6.4
8/30	4	0835	Manual (1) 28 (2) 21 Counter (1) 28 (2) 21 check o.k. JM 6.4
8/31	5	1210	Manual (1) 32 (2) 17 Counter (1) 32 (2) 17 check o.k. JM 6.4
9/1	6	0703	Manual (1) 2 (2) 2 Counter (1) 2 (2) 2 P/U JM 6.4

Sketch

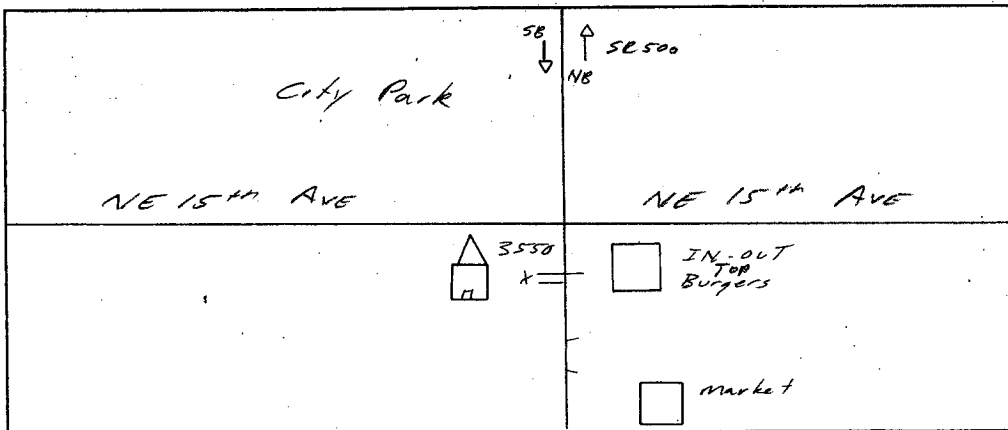

North

S.Mills

Field Person



08/28/06 MONDAY

AM HOURS	PM HOURS	DAILY TOTAL
12 1 2 3 4 5 6 7 8 9 10 11 12	1 2 3 4 5 6 7 8 9 10 11 12	
71 80 59 66 90 50 64 53 25 25 15 15 4	63 54 62 73 104 75 59 35 25 11 11 3 3	134
66 66 66 65 61 75 67 45 25 18 10 3		2261
AM PEAK HOUR 0000 TO 0000 VOLUME 82		
PM PEAK HOUR 0500 TO 0600 VOLUME 269		
AM TOTAL 79		
PM TOTAL 2261		

08/29/06 TUESDAY

AM HOURS	PM HOURS	DAILY TOTAL
12 1 2 3 4 5 6 7 8 9 10 11 12	1 2 3 4 5 6 7 8 9 10 11 12	
46 47 51 49 113 72 64 66 66 76 70 86 89 35 29 14 9	34 43 59 71 85 69 66 71 75 91 77 80 80 39 24 18 5	3883
62 52 80 78 76 64 68 69 77 68 59 59 33 20 8 3		
AM PEAK HOUR 1045 TO 1145 VOLUME 197		
PM PEAK HOUR 1200 TO 0100 VOLUME 274		
AM TOTAL 94		
PM TOTAL 2640		

08/30/06 WEDNESDAY

AM HOURS	PM HOURS	DAILY TOTAL
12 1 2 3 4 5 6 7 8 9 10 11 12	1 2 3 4 5 6 7 8 9 10 11 12	
40 53 38 56 61 73 57 58 62 72 72 65 66 51 41 16 10	30 32 53 59 63 44 55 58 63 78 71 57 55 31 30 7 7	1139
48 52 59 54 72 59 68 70 79 89 84 48 40 33 18 9 5		
AM PEAK HOUR 1100 TO 1200 VOLUME 169		
PM PEAK HOUR 0445 TO 0545 VOLUME 240		
AM TOTAL 110		
PM TOTAL 2535		
DAILY TOTAL 3672		

DOT-RNBS15A-B

STATE OF WASHINGTON - DEPARTMENT OF TRANSPORTATION  
TRIP SYSTEM  
15 MINUTE TRAFFIC COUNT SUMMARY

DATE 10/11/06  
TIME 11:45:46  
PAGE 44

SR 500 MP 018.75 OFF SYSTEM ID. LEG 2 DIRECTION OF TRAFFIC SOUTHBOUND LANE ALL OF

COUNT IDENTIFIER HPMS COUNTER NUMBER 353550 DESCRIPTION: ON SR 500 S/O NE 15TH AVE

08/31/06	THURSDAY	AM HOURS												PM HOURS												DAILY TOTAL
		12	1	2	3	4	5	6	7	8	9	10	11	12	1	2	3	4	5	6	7	8	9	10	11	
12	1	2	3	4	5	6	7	8	9	10	11	12	1	2	3	4	5	6	7	8	9	10	11	12	189	
15	4	1	2	2	6	16	22	38	40	54	57	65	79	70	77	80	82	89	78	74	24	16	12	189		
30-45	8	3	1	2	9	28	38	48	41	70	88	88	72	72	78	79	82	89	79	59	25	11	7	189		
45-00	2	4	4	3	13	31	45	46	37	38	88	77	63	64	60	86	98	89	63	37	19	14	3	189		
TOT	31	13	7	7	43	110	151	167	171	213	269	300	287	269	306	321	386	330	261	191	86	53	26	4011		
		AM PEAK HOUR 1045 TO 1145 VOLUME 285												PM PEAK HOUR 0515 TO 0615 VOLUME 393												AM TOTAL 1195
		PM PEAK HOUR 0600 TO 0700 VOLUME 96												PM PEAK HOUR 0000 TO 0000 VOLUME 0												PM TOTAL 2816

09/01/06	FRIDAY	AM HOURS												PM HOURS												DAILY TOTAL
		12	1	2	3	4	5	6	7	8	9	10	11	12	1	2	3	4	5	6	7	8	9	10	11	
12	1	2	3	4	5	6	7	8	9	10	11	12	1	2	3	4	5	6	7	8	9	10	11	12	189	
15-30	7	5	2	3	2	8	16	24	24	31	35	46	54	57	65	72	78	86	91	87	90	73	61	27	189	
30-45	3	1	1	1	1	6	21	21	21	21	21	21	21	21	21	21	21	21	21	21	21	21	21	21	189	
45-00	8	3	3	2	16	35	35	35	35	35	35	35	35	35	35	35	35	35	35	35	35	35	35	35	189	
TOT	20	9	9	4	39	96	96	96	96	96	96	96	96	96	96	96	96	96	96	96	96	96	96	96	189	
		AM PEAK HOUR 0600 TO 0700 VOLUME 96												PM PEAK HOUR 0000 TO 0000 VOLUME 0												AM TOTAL 189
		PM PEAK HOUR 0000 TO 0000 VOLUME 0												PM PEAK HOUR 0000 TO 0000 VOLUME 0												PM TOTAL 0

08/28/06 THRU 09/01/06  
TOTAL HOURS FOR COUNT 90

3 DAYS  
AVG WEEKDAY VOL 3855 X SEASONAL ADJ. FACTOR 0.8600 = 3315 X AXLE CORR FACTOR 0.9465 = ESTIMATED AVG DAILY TRAFFIC 3138

SR 500 MP 018.75 OFF SYSTEM ID. LEG 2 DIRECTION OF TRAFFIC NORTHBOUND LANE ALL OF

COUNT IDENTIFIER HPMS COUNTER NUMBER 353550 DESCRIPTION: ON SR 500 S/O NE 15TH AVE

08/28/06	MONDAY	AM HOURS												PM HOURS												DAILY TOTAL
12	1	2	3	4	5	6	7	8	9	10	11	12	1	2	3	4	5	6	7	8	9	10	11	12	TOTAL	
00-15	1	2	3	4	5	6	7	8	9	10	11	12	1	2	3	4	5	6	7	8	9	10	11	12	13	
15-30	1	2	3	4	5	6	7	8	9	10	11	12	1	2	3	4	5	6	7	8	9	10	11	12	13	
30-45	1	2	3	4	5	6	7	8	9	10	11	12	1	2	3	4	5	6	7	8	9	10	11	12	13	
45-00	1	2	3	4	5	6	7	8	9	10	11	12	1	2	3	4	5	6	7	8	9	10	11	12	13	
HOUR	1	2	3	4	5	6	7	8	9	10	11	12	1	2	3	4	5	6	7	8	9	10	11	12	13	
TOT	1	2	3	4	5	6	7	8	9	10	11	12	1	2	3	4	5	6	7	8	9	10	11	12	13	
																									2511	

AM PEAK HOUR 0000 TO 0000 VOLUME 55  
 PM PEAK HOUR 0445 TO 0545 VOLUME 286

AM TOTAL 117  
 PM TOTAL 58

08/29/06	TUESDAY	AM HOURS												PM HOURS												DAILY TOTAL
12	1	2	3	4	5	6	7	8	9	10	11	12	1	2	3	4	5	6	7	8	9	10	11	12	TOTAL	
00-15	1	2	3	4	5	6	7	8	9	10	11	12	1	2	3	4	5	6	7	8	9	10	11	12	13	
15-30	1	2	3	4	5	6	7	8	9	10	11	12	1	2	3	4	5	6	7	8	9	10	11	12	13	
30-45	1	2	3	4	5	6	7	8	9	10	11	12	1	2	3	4	5	6	7	8	9	10	11	12	13	
45-00	1	2	3	4	5	6	7	8	9	10	11	12	1	2	3	4	5	6	7	8	9	10	11	12	13	
HOUR	1	2	3	4	5	6	7	8	9	10	11	12	1	2	3	4	5	6	7	8	9	10	11	12	13	
TOT	1	2	3	4	5	6	7	8	9	10	11	12	1	2	3	4	5	6	7	8	9	10	11	12	13	
																									4047	

AM PEAK HOUR 1100 TO 1200 VOLUME 163  
 PM PEAK HOUR 0415 TO 0515 VOLUME 199

AM TOTAL 87  
 PM TOTAL 76

08/30/06	WEDNESDAY	AM HOURS												PM HOURS												DAILY TOTAL
12	1	2	3	4	5	6	7	8	9	10	11	12	1	2	3	4	5	6	7	8	9	10	11	12	TOTAL	
00-15	1	2	3	4	5	6	7	8	9	10	11	12	1	2	3	4	5	6	7	8	9	10	11	12	13	
15-30	1	2	3	4	5	6	7	8	9	10	11	12	1	2	3	4	5	6	7	8	9	10	11	12	13	
30-45	1	2	3	4	5	6	7	8	9	10	11	12	1	2	3	4	5	6	7	8	9	10	11	12	13	
45-00	1	2	3	4	5	6	7	8	9	10	11	12	1	2	3	4	5	6	7	8	9	10	11	12	13	
HOUR	1	2	3	4	5	6	7	8	9	10	11	12	1	2	3	4	5	6	7	8	9	10	11	12	13	
TOT	1	2	3	4	5	6	7	8	9	10	11	12	1	2	3	4	5	6	7	8	9	10	11	12	13	
																									3925	

AM PEAK HOUR 1100 TO 1200 VOLUME 166  
 PM PEAK HOUR 0500 TO 0600 VOLUME 157

AM TOTAL 123  
 PM TOTAL 59

08/30/06	WEDNESDAY	AM HOURS												PM HOURS												DAILY TOTAL
12	1	2	3	4	5	6	7	8	9	10	11	12	1	2	3	4	5	6	7	8	9	10	11	12	TOTAL	
00-15	1	2	3	4	5	6	7	8	9	10	11	12	1	2	3	4	5	6	7	8	9	10	11	12	13	
15-30	1	2	3	4	5	6	7	8	9	10	11	12	1	2	3	4	5	6	7	8	9	10	11	12	13	
30-45	1	2	3	4	5	6	7	8	9	10	11	12	1	2	3	4	5	6	7	8	9	10	11	12	13	
45-00	1	2	3	4	5	6	7	8	9	10	11	12	1	2	3	4	5	6	7	8	9	10	11	12	13	
HOUR	1	2	3	4	5	6	7	8	9	10	11	12	1	2	3	4	5	6	7	8	9	10	11	12	13	
TOT	1	2	3	4	5	6	7	8	9	10	11	12	1	2	3	4	5	6	7	8	9	10	11	12	13	
																									1084	

AM PEAK HOUR 1100 TO 1200 VOLUME 166  
 PM PEAK HOUR 0500 TO 0600 VOLUME 157

AM TOTAL 123  
 PM TOTAL 59

SR 500 MP 018.75 OFF SYSTEM ID. LEG 2 DIRECTION OF TRAFFIC NORTHBOUND LANE ALL OF

COUNT IDENTIFIER HPMS COUNTER NUMBER 353550 DESCRIPTION: ON SR 500 S/O NE 15TH AVE

COUNT	IDENTIFIER	HPMS	AM HOURS												DAILY TOTAL												
			1	2	3	4	5	6	7	8	9	10	11	12													
08/31/06	THURSDAY		12	1	2	3	4	5	6	7	8	9	10	11	12	1202											
			1	2	3	4	5	6	7	8	9	10	11	12	3057												
00-15			4	4	4	4	2	7	6	36	50	48	44	53	70	75	64	91	103	135	95	60	57	31	17	18	
15-30			6	4	4	4	1	8	16	42	40	34	45	57	81	64	64	69	82	104	97	58	49	35	11	18	
30-45			6	3	3	2	1	16	17	55	49	55	54	68	89	86	86	96	112	100	79	56	37	18	6		
45-00			9	4	2	3	5	12	39	45	49	48	64	75	71	80	89	107	104	97	64	57	37	20	9		
TOT			25	15	8	9	13	43	78	178	188	185	207	253	311	281	309	363	401	436	335	231	180	104	55	51	4259
											AM PEAK HOUR 1100 TO 1200 VOLUME	253											AM TOTAL	1202			
											PM PEAK HOUR 0430 TO 0530 VOLUME	455											PM TOTAL	3057			

COUNT	IDENTIFIER	HPMS	AM HOURS												DAILY TOTAL												
			1	2	3	4	5	6	7	8	9	10	11	12													
09/01/06	FRIDAY		12	1	2	3	4	5	6	7	8	9	10	11	12	147											
			1	2	3	4	5	6	7	8	9	10	11	12	147												
00-15			3	2	4	3	1	2	5																		
15-30			2	4	1	3	1	7	17																		
30-45			2	9	1	3	2	9	19																		
45-00			2	3	1	4	6	12	23																		
TOT			9	18	6	11	9	30	64																		
											AM PEAK HOUR 0600 TO 0700 VOLUME	64											AM TOTAL	147			
											PM PEAK HOUR 0000 TO 0000 VOLUME	0											PM TOTAL	0			

08/28/06 THRU 09/01/06 TOTAL HOURS FOR COUNT 90

3 DAYS AVG WEEKDAY VOL 4077 X SEASONAL ADJ. FACTOR 0.8600 = 3506 X AXLE CORR FACTOR 0.9465 = ESTIMATED AVG DAILY TRAFFIC 3318

SR 500 MP 018.75 OFF SYSTEM ID. LEG 2 DIRECTION OF TRAFFIC BOTH WAYS LANE ALL OF  
COUNT IDENTIFIER HPMS COUNTER NUMBER 353550 DESCRIPTION: ON SR 500 S/O NE 15TH AVE

08/28/06	MONDAY	AM HOURS												PM HOURS												DAILY TOTAL	
		12	1	2	3	4	5	6	7	8	9	10	11	12	1	2	3	4	5	6	7	8	9	10	11		12
00-15	12	1	2	3	4	5	6	7	8	9	10	11	12	1	2	3	4	5	6	7	8	9	10	11	12		
15-30	1	2	3	4	5	6	7	8	9	10	11	12	1	2	3	4	5	6	7	8	9	10	11	12			
30-45																											
45-00																											
HOUR																											
TOT																											

AM PEAK HOUR 0000 TO 0000 VOLUME 0  
PM PEAK HOUR 0445 TO 0545 VOLUME 744  
AM TOTAL 4772  
PM TOTAL 0

08/29/06	TUESDAY	AM HOURS												PM HOURS												DAILY TOTAL	
		12	1	2	3	4	5	6	7	8	9	10	11	12	1	2	3	4	5	6	7	8	9	10	11		12
00-15	12	1	2	3	4 <td>5</td> <td>6</td> <td>7</td> <td>8</td> <td>9</td> <td>10</td> <td>11</td> <td>12</td> <td>1</td> <td>2</td> <td>3</td> <td>4</td> <td>5</td> <td>6</td> <td>7</td> <td>8</td> <td>9</td> <td>10</td> <td>11</td> <td>12</td> <td></td>	5	6	7	8	9	10	11	12	1	2	3	4	5	6	7	8	9	10	11	12		
15-30	1	2	3	4	5	6	7	8	9	10	11	12	1	2	3	4	5	6	7	8	9	10	11	12			
30-45																											
45-00																											
HOUR																											
TOT																											

AM PEAK HOUR 1100 TO 1200 VOLUME 529  
PM PEAK HOUR 0430 TO 0530 VOLUME 755  
AM TOTAL 2411  
PM TOTAL 5519

08/30/06	WEDNESDAY	AM HOURS												PM HOURS												DAILY TOTAL	
		12	1	2	3	4	5	6	7	8	9	10	11	12	1	2	3	4	5	6	7	8	9	10	11		12
00-15	12	1	2	3	4 <td>5</td> <td>6</td> <td>7</td> <td>8</td> <td>9</td> <td>10</td> <td>11</td> <td>12</td> <td>1</td> <td>2</td> <td>3</td> <td>4</td> <td>5</td> <td>6</td> <td>7</td> <td>8</td> <td>9</td> <td>10</td> <td>11</td> <td>12</td> <td></td>	5	6	7	8	9	10	11	12	1	2	3	4	5	6	7	8	9	10	11	12		
15-30	1	2	3	4	5	6	7	8	9	10	11	12	1	2	3	4	5	6	7	8	9	10	11	12			
30-45																											
45-00																											
HOUR																											
TOT																											

AM PEAK HOUR 1100 TO 1200 VOLUME 472  
PM PEAK HOUR 0500 TO 0600 VOLUME 746  
AM TOTAL 2223  
PM TOTAL 5374

SR 500 MP 018.75 OFF SYSTEM ID. LEG 2 DIRECTION OF TRAFFIC BOTH WAYS LANE ALL OF

COUNT IDENTIFIER HPMS COUNTER NUMBER 353550 DESCRIPTION: ON SR 500 S/O NE 15TH AVE

08/31/06 THURSDAY		AM HOURS												PM HOURS												DAILY TOTAL
12	1	2	3	4	5	6	7	8	9	10	11	12	1	2	3	4	5	6	7	8	9	10	11	12		
12	1	2	3	4	5	6	7	8	9	10	11	12	1	2	3	4	5	6	7	8	9	10	11	12	336	
19	8	1	6	2	13	22	58	88	88	98	110	135	154	134	168	183	217	184	138	131	55	33	30	30		
14	7	5	3	3	6	17	44	80	75	92	127	169	142	147	150	220	176	117	102	74	60	22	25	25		
8	7	6	1	8	29	48	100	95	92	156	166	125	150	156	198	168	198	168	119	74	37	23	9	9		
15	6	3	6	10	27	74	91	84	101	134	129	141	153	152	198	191	187	137	118	64	38	30	13	13		
TOT	56	28	15	16	26	86	188	329	355	356	420	522	611	568	578	669	722	822	665	492	371	190	108	77	8270	
									AM PEAK HOUR 1045 TO 1145 VOLUME												AM TOTAL			2397		
									PM PEAK HOUR 0445 TO 0545 VOLUME												PM TOTAL			5873		

09/01/06 FRIDAY		AM HOURS												PM HOURS												DAILY TOTAL
12	1	2	3	4	5	6	7	8	9	10	11	12	1	2	3	4	5	6	7	8	9	10	11	12		
12	1	2	3	4	5	6	7	8	9	10	11	12	1	2	3	4	5	6	7	8	9	10	11	12	336	
10	7	6	3	3	3	10	21																	21		
5	5	5	2	4	4	16	41																	41		
10	12	2	4	4	3	15	40																	40		
4	3	2	6	11	28	58																		58		
TOT	29	27	15	15	21	69	160		AM PEAK HOUR 0600 TO 0700 VOLUME												AM TOTAL			336		
									PM PEAK HOUR 0000 TO 0000 VOLUME													PM TOTAL			0	

08/28/06 THRU 09/01/06 TOTAL HOURS FOR COUNT 90

3 DAYS AVG WEEKDAY VOL 7932 X SEASONAL ADJ. FACTOR 0.8600 = 6822 X AXLE CORR FACTOR 0.9465 = ESTIMATED AVG DAILY TRAFFIC 6457

PEAK HOUR PERCENTAGES: K = 10.41 D = 55.08

PEAK HOUR LOCATION : VOLUME = 826 DATE: 08/31/06 TIME: 04:30 PM